

*IceToolz*

en 2025

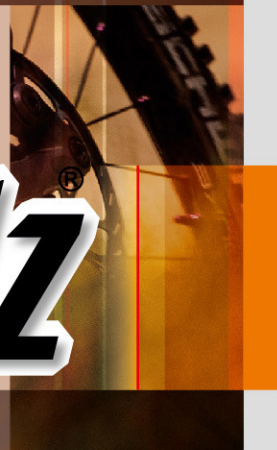

***IceToolz***



### 01-02 What's New

**03** Headset Wrenches

**04** Pedal and Axle Wrenches

**05-06** Crank & Chainring Tools

**07** Bottom Bracket Tools

**08-10** Frame & Fork Tools

**11** Cable Tools

**12-13** Brake Tools

**14-15** Chain Tools

**16-17** Freewheel & Cassette Tools

**17** Cone Wrenches

**18-20** Wheel Service

**21-22** Tire Service

**23** Torque Wrenches

**24-27** General Tools

**28-29** Hex and Star (Torx®) Wrenches

**30-31** Multi Tools

**32-34** Air Pumps

**34-37** Cleaning & Lubrication

**38-39** Repair Stand

**40-41** Tool Kits

**42-43** Display & Storage

**44** Safety

**44** Accessories



**23** Torque Wrenches



**30-31** Multi Tools



**38-39** Repair Stand



**24-27** General Tools



**32-34** Air Pumps



**40-41** Tool Kits



**28-29**  
Hex and Star (Torx®) Wrenches



**34-37**  
Cleaning & Lubrication



**42-43** Display & Storage



**44** Safety



Third party brand / product names used herein are used to identify such products and are for descriptive purposes only. Such names may be marks and / or registered marks of their respective owners.

## Online Video



# 2025 What's New



## 82F6

### ***IceToolz CarbonFix Tool Kit 82F6***

***The tool set for maintaining your beloved carbon fiber bicycle.***

Ensures precise maintenance of carbon fiber bicycles with a torque wrench, anti-slip compound, quick-link pliers, and space for bottom bracket sockets.

#### **Everything you need in one place**

Effortlessly handles bike adjustments, cleaning, maintenance, and basic repairs.



#### **Designed with carbon bikes in mind**

Ensures screws and components are tightened correctly to protect the carbon fiber.



#### **Keep your bike pristine**

Simplifies chain removal for cleaning and maintenance, avoiding damage from harsh detergents.

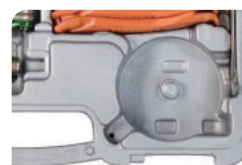

#### **Never lose your bottom bracket tool**

Reserved for M series bottom bracket sockets, purchased separately.



## E173D

### ***IceToolz T47 Tap Set E173D***

Our tap set with new specification T47 M47 x 1.0 left-hand threading and M47 x 1.0 right-hand threading.



## E215

### ***IceToolz Precision Torque Wrench E215***

Familiar torque wrench, now with better compatibility. 2 - 24 Nm 1/4" Drive.



## 54R5

### **IceToolz Bleed Kit 54R5**

Now supporting SHIMANO® and SRAM® Bleeding Edge™ Brake System

Designed to be compatible with most hydraulic disc brake systems. Compatible with road and mountain bike systems from AVID®, FORMULA®, HAYES®, MAGURA®, SHIMANO® and SRAM®.



#### **Bleed out your brake oil**

Designed to be compatible with most hydraulic disc brake systems.



#### **D.O.T. or Mineral? Make your own choice**

Suitable for use with both mineral oil and DOT brake fluid. Do not switch the bleed kit between different kind of fluid.



#### **Supports SHIMANO® System**

Support SHIMANO® Brake System with included IceToolz Bleed Kit Adapter 54R3G.



#### **Quick release for speed**

Features quick-release connectors for fast and secure connection of the syringe and adapter hose.



#### **Start and Stop on your command**

Equipped with two hose clamps to control the flow of the oil.



#### **Supports SRAM® Bleeding Edge™ system**

Support SRAM® Bleeding Edge™ System with included special hose.

Customer who owns IceToolz Bleed Kit 54R4 can purchase IceToolz Upgrade kit for 54R4 (54R3J) separately.

## **Why pay for the full set when you only need one specific type?**

**Only need a kit for bikes with SRAM® system?  
We got you covered**



## 54R3K

### **IceToolz 54R3K Bleed Kit for SRAM®**

Contain everything you need to work on SRAM® brake system





## Headset Wrenches



**06C3** 5-in-1 Headset Wrench

- 30 x 32 x 36mm headset wrench
- Freewheel turner
- Lockring tool



**06F2** 32mm Headset Wrench



**06H8** 4-in-1 Headset Wrench

- 30 x 32 + 36 x 40mm headset wrench



**E148** Headset Cup / BB Cup Press Tool

- For 29.9, 33.9, 36.8, 40.9, 43.8, 46.7, 51.7, 54.8mm headset cups
- For Press-Fit system 22/ 24/ 30mm I.D. bearings
- Max working length of 210mm



- M100** Headset Lock Nut Installation Tool - 30mm
- M106** Headset Lock Nut Installation Tool - 36mm
- M127** Headset Head Cup Installation Tool - 47mm

# Pedal and Axle Wrenches

## 33S1 15mm Pedal Wrench

- Offset design.
- Ergonomic handle with long anti-slip grip.
- 3/8" square hole for use with a torque wrench to prevent damage to parts.

## 34S2 Tool for Single Speed Chain Whip, Pedal, Lockring

- Lockring tool
- Freewheel turner (chain whip, 1/2" x 1/8")
- 15mm pedal wrench
- Perfect tool for single-speed bikes

## 34S4 Tool for Multi Speed Chain Whip, Pedal, Lockring

- Lockring tool
- Freewheel turner (chain whip, 1/2" x 3/32")
- 15mm pedal wrench

## 3400 Pedal & Axle Wrench

- 15mm pedal wrench
- 14x15mm sockets for crankarm bolts and axle nuts

## 34B1 Pedal & Axle Wrench

- 15mm pedal wrench
- 14 socket for crankarm bolts and axle nuts

## 33F5 15mm Pedal Wrench

- Helps mount and remove bike pedals.
- For tightening and loosening pedals with a comfortable ergonomic grip.
- 3/8" square hole for use with a torque wrench to prevent damage to parts.

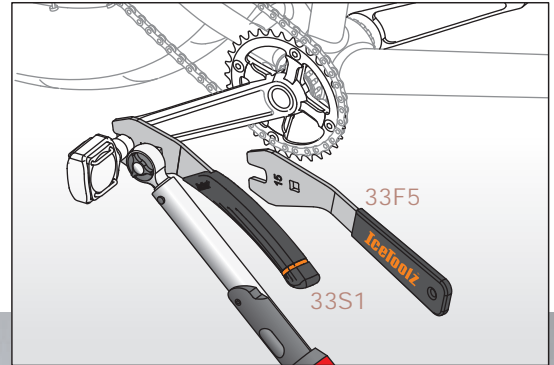

## 33D1 Dummy Pedal

- Ideal for bike repair and assembly use.
- Easy and efficient mounting and dismounting to rotate the crank.

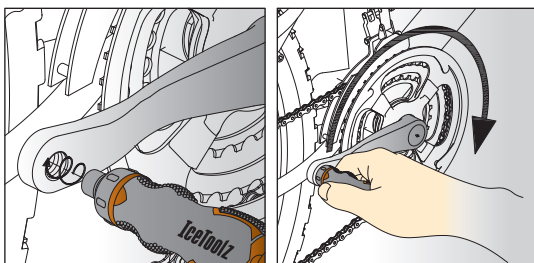

## E152

- Pedal Tap, 1/2" x 20TPI (left + right)

## E154

- Pedal Tap, 9/16" x 20TPI (left + right)



# Crank & Chainring Tools

## 04C2 Crank Remover

- Interchangeable adaptor fits square and hollow axles.
- Use with 8mm hex key wrench (#35V8).

## 04D2 Crank Extractor

- Includes 14 x 15mm sockets and 8mm hex key for crank bolt and arm removal.
- Interchangeable adaptor suits both square and hollow axles.

## 04S1 Crank Tool with Ergonomic Handle

- Equipped with 14 x 15mm sockets and 8mm hex key for crank bolt and arm removal.
- Interchangeable adaptor fits square and hollow axles.

## 04T1 Crank Arm/Cap Installation Tool

- For Shimano® Hollowtech II

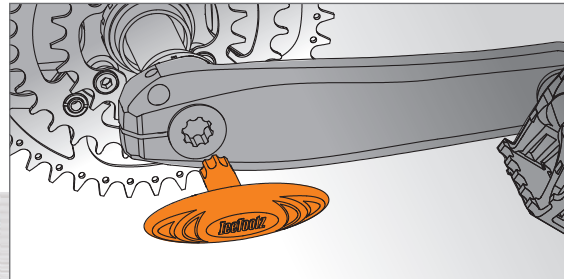

## 2741 Chainring Lock Ring Tool

- For Shimano® FC-M91xx/ FC-M81xx/ FC-M71xx series



## 27P5 Chainwheel Nut Tool

- Double-ended design for most slotted-type chainwheel nuts, and crank dust caps
- Securely holds the slotted nut to prevent springing





### M582 Shimano® Chainring Mounting Tool

- Compatible for Shimano® DU-EP800/ E8000/ E7000/ E6100/ E5000 and FSA Spider
- Use with 1/2" Two-way Ratchet Wrench (#43R4x)

### M583 Shimano® Chainring Mounting Tool

- Compatible for Shimano® SM-CRE60 (STePS)
- Use with 1/2" Two-way Ratchet Wrench (#43R4x)

### M585 Shimano® Chainring Mounting Tool

- Compatible for Shimano® DU-EP5/ EP6/ EP801
- Use with 1/2" Two-way Ratchet Wrench (#43R4x)

### M801 BOSCH® Lockring Tool

- Compatible for Bosch® Active / Performance Line till 2019
- Use with 1/2" Two-way Ratchet Wrench (#43R4x)

### M803 Lockring Tool for Bosch® Gen3/4, YAMAHA® PW-X

- Compatible for Bosch® Gen. 3 and 4 and Yamaha® PW-X drives
- Use with 1/2" Two-way Ratchet Wrench (#43R4x)



Innovation Award



### E521 Stripped Pedal Threads Repair Kit

- Ideal for repairing and restoring damaged threads on high-end crank arms.
- Includes one set of tap and five helicoil threads (9/16" x 20TPI) for right and left crank arms.
- Ergonomic handle for use with the tap to enlarge stripped pedal threads.
- Comfortable rubber-grip handle for installing helicoil threads.
- Includes one cleaning brush.
- Includes one bottle of #C143 cutting fluid (2oz / 60ml).



### E521H 9/16" Helicoil Threads

- Set of 5 pairs
- Use with the #E521 Stripped Pedal Threads Repair Kit only



### E521T Thread Tap Set for #E521

- For enlarging stripped pedal threads on damaged crank arms.
- Use with the #E521 Stripped Pedal Threads Repair Kit only.

# Bottom Bracket Tools



## 11T1 Bottom Bracket Tool Retaining Kit

- For 1/2-inch drive bottom bracket tools (excludes non-hollow bottom brackets).
- Spring-based tension system ensures secure engagement and prevents slippage.

## B.B. Tools List

Parts Specifications	Parts Number for Reference	SHIMANO® TL	IceToolz	Driver
Campagnolo® splined 12-Tooth Adjustable BB cup pegs/pins tool			09B3 11A0	1/2" Driver
Cartridge / OCTALINK®	BB-5500, 6500 & ES25 BB-UN26	TL-UN74-S	11B1	1/2" Driver
8-Notch 44mm O.D. cups		TL-UN96	11B3	32mm wrench
BB and headset locking tool			11D3	32mm wrench
22/24/30mm I.D. bearings	Press-Fit system		11H1	
3-Notch 46mm O.D. locking			11R3	
			M083	1/2" Driver
16-Notch 44mm O.D. cups	Shimano® SM-BB4600, BB51, BB52, BB5700, BB-RS500, BB6700, BB70, BB7900 & BB80 Campagnolo®, Chris King® SRAM®/Truvativ® GXP, FSA MegaExo® Hope®, Race Face® X-type, Surly® Wheels Manufacturing™, Fulcrum® Bafang® BBSH, BBS02 mid-drive e-bike motor lockrings.	TL-FC32/33/36	11C1 11F3 M091	8mm hex key 1/2" Driver
16-Notch 41mm O.D. cups	Shimano® Ultegra® BBR60, Deore XT® MT-800	TL-FC25/37	11C3 M093	1/2" Driver
16-Notch 39mm O.D. cups	Shimano® XTR® BB93 Shimano® Dura-Ace® BB9000	TL-FC24/34	11C5 M095	1/2" Driver
12-Notch 46mm O.D. cups	SRAM® DUB™, Race Face® Cinch™ Rotor® BSA30, Zipp® Vuma™ Hawk Racing™ BB3086™		11C7 M097	1/2" Driver
12-Notch 50.4mm O.D. cups	BBInfinite® T47 Chris King® ThreadFit™ T47 & ThreadFit™ 30 Enduro® BBright® TorqTite®, Hambini T47 Rotor® T47 External 30 mm & BBright®, BB30, BB386EVO, and PF30 thread-together		M098	1/2" Driver
16-Notch 52.2mm O.D. cups	FSA® MegaEvo® Wheels Manufacturing™ T47 & PF30		M099	1/2" Driver
12-Notch 48~50mm O.D. cups	Praxis Works® M30		M030	1/2" Driver
16-Notch 53mm O.D. cups	Colnago Threadfit 82.5		M045	1/2" Driver

## Frame & Fork Tools



**E114** Star Nut Installation Tool

- For 1", 1-1/8", and 1-1/2" fork steerer

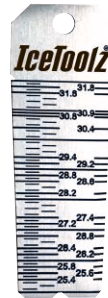
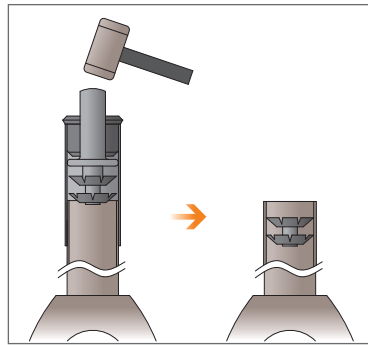

**E326** The Wat Seat Tube Gauge

- Takes the hassle out of finding the right seat post
- Measures from Ø25.0 ~ Ø31.8mm

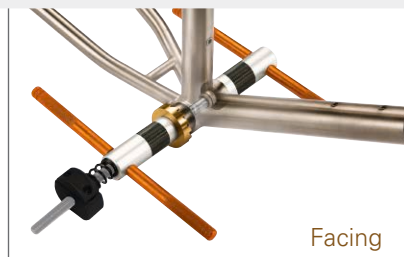

Facing

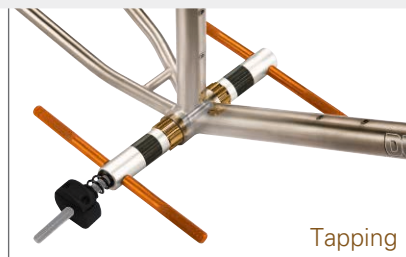

Tapping

**E175** BB Tapping & Facing Tool, English

- For English threading (1.37" x 24TPI).
- Performs facing and tapping.



**E181** Head Tube Reaming & Facing Tool

- For 1" and 1-1/8" conventional headset systems.
- Includes #E181A, #E181B, and #E181F components.



**E185** BB Tapping & Head Tube Reaming & Facing Set

- For 1" and 1-1/8" conventional headset systems
- Kit includes: #E171F, #E171L, #E171R, #E171T, #E173L, #E173R, #E173T, #E181A, and #E181B
- Please refer to the next page for other cutters

Please refer to the next page for other cutters



**E355** Derailleur Hanger Alignment Tool

- For rim size 18" ~ 30"





<b>E173D</b>	T47 Bottom Bracket Tap Set	T47 (M47 x 1.0P). Includes the drive side (Golden) and non-drive side (Black).
<b>E173R</b>	Tap	English (1.37" x 24TPI), for right side, Golden
<b>E173L</b>	Tap	English (1.37" x 24TPI), for left side, Black
<b>E173T</b>	Tap	Italian (1.37" x 24TPI), Green
<b>E171N</b>	Bottom Bracket Reaming & Facing Cutter	Ø41mm for BB86/92, PF24, PF41. H.S.S.
<b>E171M</b>	Bottom Bracket Reaming & Facing Cutter	Ø46mm for PF30. H.S.S.
<b>E171R</b>	BB Screw	English (1.37" x 24TPI), for right side, Golden
<b>E171L</b>	BB Screw	English (1.37" x 24TPI), for left side, Black
<b>E171T</b>	BB Screw	Italian (1.37" x 24TPI), Silver
<b>E181L</b>	Centering Cone	For Head Tube inner Ø48~54mm. Usually used in conjunction with E181S
<b>E181F</b>	Head Tube Facer	Up to Ø45mm
<b>E171F</b>	BB & Head Tube Facer	Up to Ø55mm
<b>E181C</b>	Head Tube Reamer	Ø34mm for 1-1/8" conventional headset systems. Chris King®
<b>E181G</b>	Head Tube Reaming & Facing Cutter	Ø41.4mm for Cane Creek®. 1-1/8" ZS compatible low profile headset systems. H.S.S.
<b>E181S</b>	Head Tube Reaming & Facing Cutter	Ø49.6mm for 1-1/2" OnePointFive headset systems. H.S.S.
<b>E181T</b>	Head Tube Reaming & Facing Cutter	For Campagnolo® Hiddenset compatible integrated headset systems, top. H.S.S.
<b>E181P</b>	Head Tube Reaming & Facing Cutter	For Cane Creek®. 1-1/8" IS compatible integrated headset systems, top. H.S.S.
<b>E181U</b>	Head Tube Reaming & Facing Cutter	For Campagnolo® Hiddenset compatible integrated headset systems, bottom. H.S.S.
<b>E181R</b>	Head Tube Reaming & Facing Cutter	For Cane Creek®. 1-1/8" IS compatible integrated headset systems, bottom. H.S.S.
<b>E181V</b>	Head Tube Reaming & Facing Cutter	For FSA® Integrated #44 series headset systems, 1-1/8", top. H.S.S.
<b>E181W</b>	Head Tube Reaming & Facing Cutter	For FSA® Integrated #44 series headset systems, 1-1/4", bottom. H.S.S.



**E253 Crown Race Remover**

- Up to 1-1/2"



**E263 Frame & Fork Adjuster**

- Designed for expanding and compressing steel forks, chain stays, and seat stays.
- Trapezoidal thread provides extra power and extends tool life.
- Features protective rubber where the tool contacts the bike.

**E263S Spare Rubber Pads for #E263**

- Set of 4 pieces



**E272 Shuriken Disc Mount Sanding Tool**

- Sands the paint flat on disc mount surfaces for precise mounting.
- Patented.



**E291 Bearing Puller**

- For BB30, BB86, BB92, and Campagnolo® Ultra-torque
- For bearing cup of outer Ø40mm ~ 45mm

**E291S Spare Claws for #E291**

- Set of 2 pieces

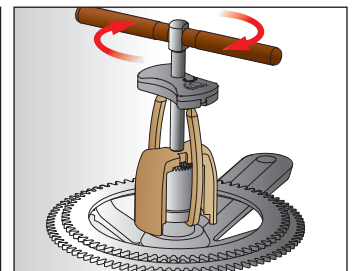
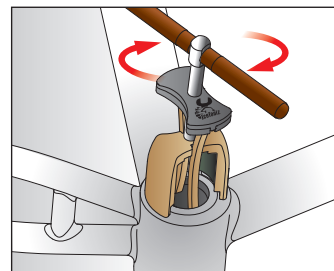

**E221 Headset Cups Remover**

- For 1" and 1-1/8"

**E223 Headset Cups Remover**

- For 1-1/4" and 1-1/2"



**E293 Press-fit Bearing Removal Tool**

- For internal diameter Ø24mm ~ 30mm bottom bracket bearings



**E294 Press-fit Bearing Removal Tool**

- For internal diameter Ø35mm ~ 46mm bottom bracket bearings

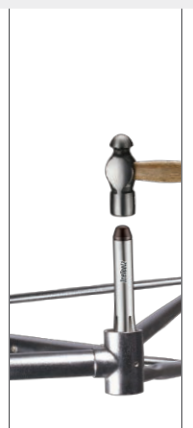



## Cable Tools



### 01A1 Cable Pliers

- Thumb lock secures cables for one-handed operation.
- Soft-coated handle ensures comfortable grip.
- Ideal for shop, home, or professional use.

67R2

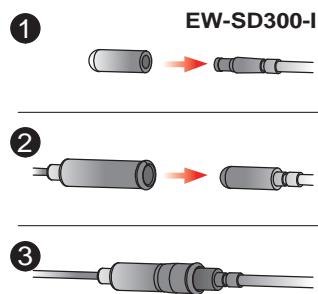

### 67R2 Adapter for Di2 EW-SD300-I Wire, for Use with #67R1

### 67R3 Internal Routing Tool

- Easy installation for cables, wires, and Di2 inside the bike frame.
- Plastic-coated stainless steel wire (250mm) with a magnet at the end.
- Suitable for carbon fiber, titanium, and aluminum frames.
- Opposite polarity magnet to seek or attach inside frames.
- Suitable for holes larger than 6mm.
- For Di2 EW-SD50-I & EW-SD300-I wires.

67R3



### 67A5 Pro Shop Cable & Spoke Cutter

- For Shimano® SIS SP
- Contains inner wire (Max. Ø3.5mm) and outer casing (Max. Ø7.0mm) reconditioner

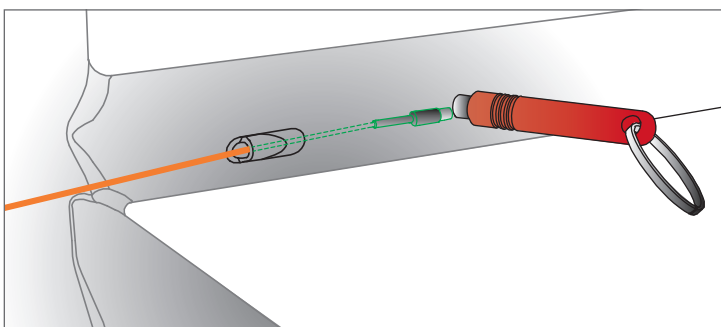

### 67B4 Cable & Spoke Cutter

- For Shimano® SIS SP



# Brake Tools



## 54R4 Bleed Kit, Version 3

- Universal design for all hydraulic disc brake systems
- Compatible with SRAM®, FORMULA®, HAYES®, MAGURA®, and SHIMANO®
- Suitable to use with Mineral and DOT fluid
- With one pair of NBR Gloves (#17G3)
- M5 to M7 adapter for SHIMANO® 105, ULTEGRA or DURA-ACE systems
- New syringes with adapter to fix on the syringe & PU tubes tightly
- With a releasable cable tie which can fix the PU tubes onto the calipers
- With two pieces tubing clips to on/off the flow of syringes

## 54R3J

- For Sram Bleeding Edge



## 54R3K Bleed Kit

- For Sram Bleeding Edge set



## 54R3G Adapter for M5x1.0P to M7x0.75P



## 54R3H Adapter with PU hose for #54R3

- ID: ø4mm
- Luer taper



## 54R3S Syringes for #54R3

- 60ml
- Luer taper



## 54R5 Bleed Kit, Version 3 with SRAM Bleeding Edge Adapter (54R3J).

## 54A1 Hydraulic Hose Cutter

- Flawlessly cuts hoses and prevents inner tube deformation.
- Contains one spare blade (#54A1S).



54A1S  
Spare Blade for #54A1

## 54B1 Disc Brake Piston and Pad Alignment Tool

- Reposition pistons
- With ergonomically designed handle for comfortable grip
- Easy to use

## 54P5 Lipstick Needle Driver

- Designed for inserting hydraulic needle joints into hoses with perfect alignment.
- Prevents damage when inserting soft brass fittings into hydraulic cables.
- Handy for installing or repairing bike brake and hydraulic hose systems.



## 55B1 Croco Brake Shoe Tuner

- Aligns rim brake pads easily and quickly.
- Adjustable for rim widths 15mm ~ 40mm and a max depth of 60mm.
- Patented.

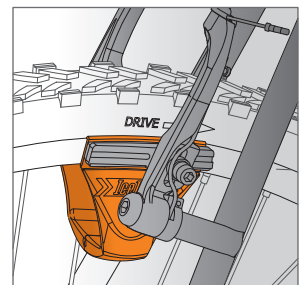



### M082 SHIMANO® Disc Brake Lockring Tool

- Compatible for SHIMANO® Disc Brake Lockring - Externally serrated type
- Deepness: 34mm, for both QR-type and Nut-type hubs
- Use with 1/2" Torque Wrench (#E211 / #E214)



### 54H1 8x9mm Hose Wrench

- Maintains the disc brake



### 54T1 Brake Fluid Tester

- Test the brake fluid quality quickly to check whether it's qualified



### 54RA Pneumatic Vacuum Brake Bleeder

- Quick Coupling C Type & ARO210 Type

### 54RB Pneumatic Vacuum Brake Bleeder

- Quick Coupling C Type & ISO 6150 B Type

### 54RC Pneumatic Vacuum Brake Bleeder

- Quick Coupling C Type

### 54RE Pneumatic Vacuum Brake Bleeder

- Quick Coupling C Type & Euro Type



### 55A3 Disc Rotor Truing Tool

- Adjust disc up to 45mm / 1.75"



### 55B3 Disc Brake Caliper Alignment Tool

- Simple and easy alignment of disc brakes.
- Made from SUS304 stainless steel.





# Chain Tools

62B3



62B7



62M1



61M1



29M1



29M2



## 62B3 Pro Shop Chain Tool for Single Speed

- For 1/2" x 3/32", 1/2" x 1/8" BMX chains, including YBN® "Offset Link" chains.
- Thumb-lid isolates fingers from greasy chains while positioning the chain correctly.
- Includes connecting rivet pilot pin breaker.



Offset Link Chain

## 62B7 Pro Shop Chain Tool for Electric Bike Chains

- For 1/2" x 3/16" chains.
- Thumb-lid isolates fingers from greasy chains while positioning the chain correctly.
- Includes connecting rivet pilot pin breaker.



Connecting Pilot Pin Breaker

## 62M1 Pro Shop Chain Tool for Shimano® Chains

- Perfect for 5 ~ 12-speed chains.
- For Shimano® compatible HG/ UG/ IG chains.
- Thumb-lid isolates fingers from greasy chains while positioning the chain correctly.
- Includes connecting rivet pilot pin breaker.

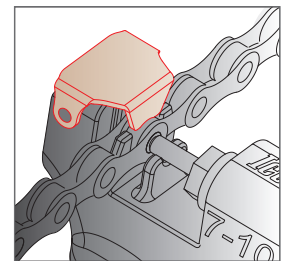

Thumb-lid

## 61M1 Portable Chain Tool

- Perfect for 5 ~ 12-speed chains.
- For Shimano® compatible HG/ UG/ IG chains.
- Thumb-lid isolates fingers from greasy chains while positioning the chain correctly.
- Includes chain hook for installing chains.
- Comes with a chain connectors case.
- Flat design for pocket storage.
- Patented.

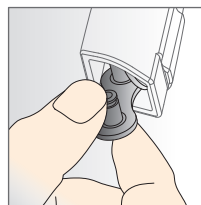

With Chain Connector Case

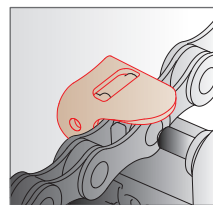

Thumb-lid

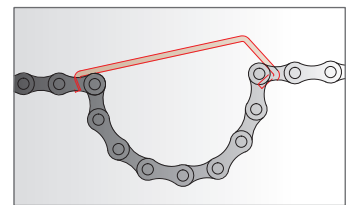

Chain Hook

## 29M1 Shimano® Compatible Chain Tool

- Perfect for 5~12-speed chains
- For Shimano® compatible HG/ UG/ IG chains

## 29M2 Shimano® Compatible Chain Tool

- Perfect for 5 ~ 12-speed chains
- For Shimano® compatible HG/ UG/ IG chains
- Long handle





**29B2S** Spare Shaft for #29B2, #29M1



**29C2S** Spare Shaft for #29C2



**61A3S** Spare Shaft for #61A3, #61U0



**62P3S** Spare Shaft for #62xx series

- Spare Shaft for #62B3, #62B7, #62M1, #62P3, #62U3

### 62D3 Master Link Pliers

- 2-in-1 tool for Master Link assemble and disassemble

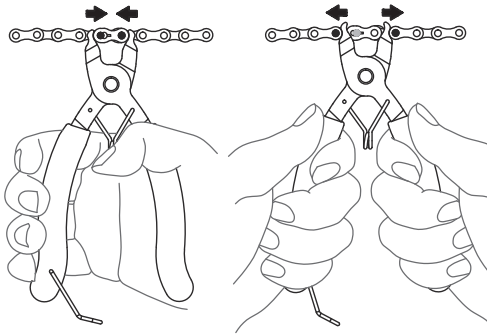

### 62H1 Foldable Chain Hook

- Hooks chains when installing them.



### 62C4 Stainless Steel Go / No-go Chain Checker

- Instantly advises when it's time to change the chain.

62D3

62H1

62C4

30C1



**61A4S** Spare Shaft for #61A4, #61A5, #61M1

### 30C1 ChainMaster

- For rear chain stay, dropout, and derailleur protection during travel.
- Adjustable to fit axle lengths: 130, 135, 160, and 165mm.
- Quick release not included.

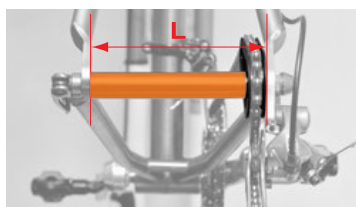

$$L=130\text{mm}=a+d$$

$$L=135\text{mm}=a+b+d$$

$$L=160\text{mm}=a+c+d$$

$$L=165\text{mm}=a+b+c+d$$



Quick release not included.

# Freewheel & Cassette Tools



<b>0900</b>	Suntour® 2-notch Freewheel Remover	For Suntour® 2-notch freewheel. (23mm spanner)
<b>0903</b>	Suntour® 2-notch Freewheel Remover	For Suntour® 2-notch freewheel. (23mm spanner)
<b>09B3</b>	Freewheel / Cassette Tool	For with Shimano® MF freewheels, Campagnolo® cassettes, and 12-spline bottom bracket cups on square spindle systems (#43R41). Use with a 21mm spanner.
<b>09C1</b>	Cassette Lockring Tool with Guide Pin	For Shimano® CS, SRAM, SunRace, Chris King For cassettes and Shimano® Center Lock disc brakes. Guide Pin Ø6mm. (#43R41) or 21mm spanner
<b>09C2</b>	Cassette Lockring Tool with Guide Pin	For Shimano® CS, SRAM, SunRace, Chris King For cassettes and Shimano® Center Lock disc brakes. Guide Pin Ø12mm. (#43R41) or 21mm spanner
<b>09C3</b>	Shimano® Cassette Lockring Tool	For Shimano® CS, SRAM, SunRace, Chris King For cassettes and Shimano® Center Lock disc brakes. (#43R41) or 21mm spanner
<b>09C5</b>	Freewheel / Cassette Lockring Tool	For Shimano® CS, SRAM, SunRace, Chris King compatible cassettes and Shimano® Center Lock disc brakes. Also for Shimano® MF compatible freewheels & Campagnolo® cassettes (all) and Athena. (#35V8)
<b>09D1</b>	2-notch Freewheel Remover	For 2-notch freewheels. (24mm spanner)
<b>09E1</b>	4-notch Freewheel Remover	For 4-notch freewheels. (24mm spanner)
<b>09F0</b>	Suntour® 4-notch Freewheel Remover	For Suntour® 4-notch freewheel. (24mm spanner)

#35V8 - 8mm kex key (Page 29)

#43R41 - 1/2" Two-way ratchet wrench (Page 26)

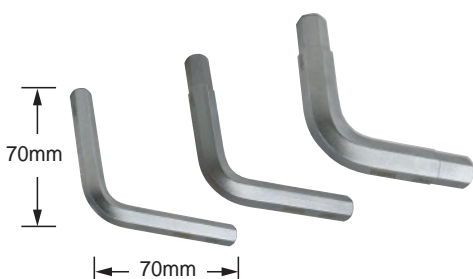

## 37H1 Hub Body Removal Tool

■ 10x10mm

## 37H2 Hub Body Removal Tool

■ 11x12mm

## 37H3 Hub Body Removal Tool

■ 14x15mm

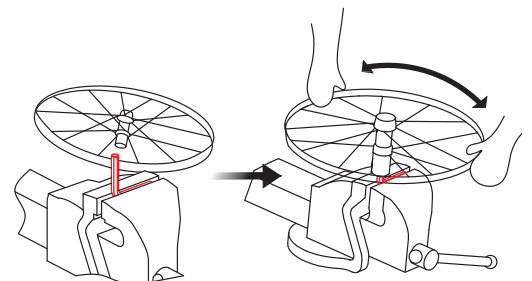

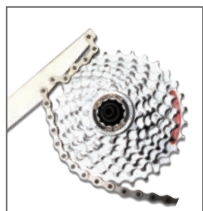

### 53A2 Freewheel Turner (Chain Whip, 1/2" x 3/32")

- Compatible for multi-speed
- With chain whip 1/2" x 3/32"



### 53S1 Freewheel Turner (Chain Whip, 1/2" x 1/8")

- Compatible for single-speed
- With chain whip 1/2" x 1/8"
- Ergonomic handle with long anti-slip grip



### 53S3 Freewheel Turner (Chain Whip, 1/2" x 3/32")

- Compatible for multi-speed
- With chain whip 1/2" x 3/32"
- Ergonomic handle with long anti-slip grip

## Cone Wrenches







<b>4713~4719</b> <b>4720~4725</b>	Cone Wrench	4713~4719: 13/ 14/ 15/ 16/ 17/ 19mm with 20cm handle 4720~4725: 20/ 21/ 22/ 23/ 24/ 25mm with 23cm handle
<b>47X3</b>	Cone Wrench Set	13+15+17mm, Set of 3 Pieces (#4713 + #4715 + #4717)
<b>47X7</b>	Cone Wrench Set	13+14+15+16+17+18+19mm, Set of 7 Pieces (#4713 + #4714 + #4715 + #4716 + #4717 + #4718 + #4719)
<b>0502</b>	Cone Wrench Set	13x15 + 14x16mm, Set of 2 pieces
<b>37A1</b>	Double-Ended Cone Wrench	13x14mm
<b>37B1</b>	Double-Ended Cone Wrench	15x16mm
<b>37C1</b>	Double-Ended Cone Wrench	17x18mm
<b>37X3</b>	Double-Ended Cone Wrench Set	37A1+37B1+37C1 (13x14mm + 15x16mm + 17x18mm). Set of 3 pieces
<b>37H1</b>	Hub Body Removal Tool	10x10mm
<b>37H2</b>	Hub Body Removal Tool	11x12mm
<b>37H3</b>	Hub Body Removal Tool	14x15mm



# Wheel Service



<b>08P1</b>	Spoke Tool - Black vinyl coated - For 3.20mm/ 80 ga./ 0.127" nipples	
<b>08P2</b>	Spoke Tool - Green vinyl coated - For 3.30mm/ 80 ga./ 0.130" nipples	
<b>08P3</b>	Spoke Tool - Red vinyl coated - For 3.45mm/ 80 ga./ 0.136" nipples	
<b>08C5</b>	Stainless Steel Spoke Tool - For 3.45mm/ 80 ga./ 0.136" nipples	
<b>12B8</b>	Spoke Tool - For 3.2mm (Square) nipples. Use T-handle for high torque tightening.	 3.2mm
<b>12C3</b>	Spoke Tool - For 5.5mm (Hex) nipples. Use screwdriver handle for rapid turning.	 5.5mm
<b>12C6</b>	Spoke Tool - For 5.5mm (Hex) nipples. Use T-handle for high torque tightening.	 5.5mm
<b>12C7</b>	Spoke Tool - For 5.5mm (Hex) nipples. Use T-handle for high torque tightening.	 5.5mm
<b>12D6</b>	Spoke Tool - For 3.6mm (Square) nipples. Use T-handle for high torque tightening.	 3.6mm
<b>12H4</b>	Spoke Tool - For Mavic® wheel systems	

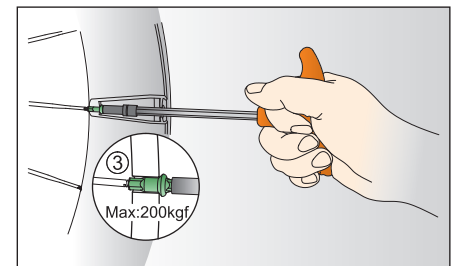
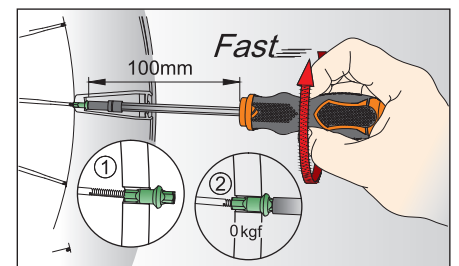

**12C5**  
**12C3 & 12C7**

Spoke Tool - For 5.5mm (Hex) nipples  
Use screwdriver handle for rapid turning and T-handle for final tightening.





### 12S4 Nipple Wrench for Deep Rims

- The V-spring holds the nipple to screw onto deep rims, preventing it from dropping.
- With control function to release the nipple after 3 ~ 4mm on the spoke.
- Can also be used with a 1/4" electric screwdriver.



Set of 2 pieces

### 12S4S Spare V-spring for #12S4, #12S5 (Set of 2).



### 1206 6-groove Spoke Wrench

- For 10 ~ 15 gauge nipples
- For home workshop use

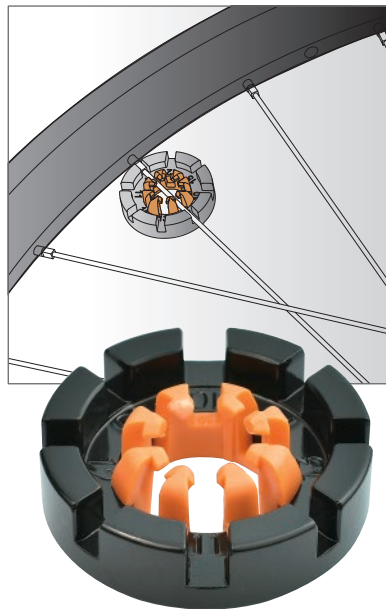

### 12F8 Forged 8-groove Spoke Wrench

- For 10 ~ 15 gauge nipples
- With spoke holder for more efficient wheel building
- Heat treated for professional grade durability
- Patented



### 12T4 Bladed Spoke Catcher

- For thickness 0.9 ~ 2.0mm

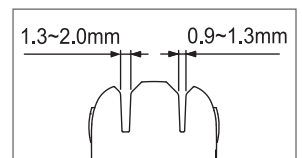

### E127S Dial Gauges Upgrade Kit

- For upgrade to E128 Pro Shop Truing Stand.



### E127T Through-Axle Adaptor

- Use with #E127, #E128, #E129 Truing Stand
- Conical design to be used for shaft diameter 11mm ~ 20mm
- Suitable for hub widths 100 ~ 150mm





### E129 Turing Stand

- Single-arm design, fits 18" ~ 29" rims.
- Heavy base design increases stability.



### E129T #E129 Truing Stand with #E127T Through-Axle Adaptor

- For 100mm front hub
- Outer rim up to 32mm
- Includes E127T kit for thru-axle hubs.



### E129V #E129 Truing Stand with Dial Gauge and Thru-Axle Adaptor



### E129W Washer For #E129, #E129T and #E129V

- For 100mm front hub
- Outer rim up to 32mm



### E312 Wheel Centering Gauge

- For rim size 16" ~ 31"



### E313 Wheel Centering Gauge with Meter

- For rim sizes 16" ~ 31".
- Measures to a 0.1mm tolerance.
- Black tolerance tabs allow quick assignment of acceptable tolerance ranges.



### E381 Spoke Tension Meter

- For rim size 18" and up
- With Japanese Mitutoyo® analog meter
- Scales to 0.01mm



### E383 Digital Spoke Tension Meter

- For rim size 18" and up
- With Japanese Mitutoyo® digital meter
- Scales to 0.01mm



## Tire Service



### 64P3 POM Tire Levers

- Set of 3 pieces.
- Unique V-shaped design can be fixed easily on spokes.
- Air vent function added on the back.
- Smart V-shaped design acts as a fulcrum on the rim for tire removal.
- Patented.



### 1903 Steel Tire Lever Set

- Zinc plated
- Set of 3 pieces

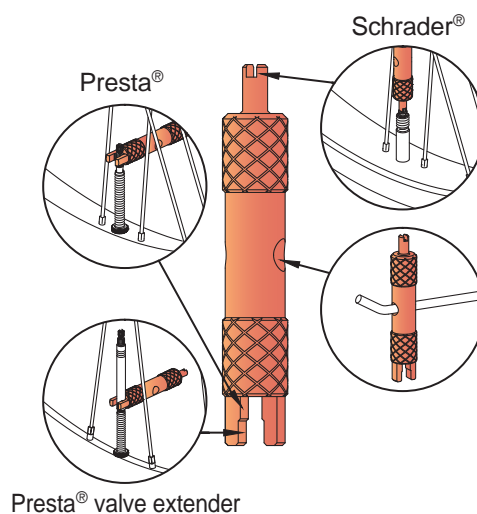

### 66V1 Valve Core Tool

- For Presta & Schrader
- Presta valve extender



### 64D3 Downhill Tire Lever

- Works for most stubborn bicycle tires.
- Metal parts covered with durable nylon for extra protection on aluminum and carbon fiber rims.



### 64H2 Heavy Duty Steel Tire Lever

- Forged, zinc plated
- 200mmL



### 64A2 Clamp-Type, Duo-functional Tire Tool

- Transformable from a traditional tire lever to a new A shaped design for easier tire mounting



### 64X1 X-Type Tire Pliers

- A convenient tool for easily installing tires onto rims.
- Ideal for tight tire and rim fits.
- Suitable for tires up to 45mm (1.7") wide.
- Compatible with both mountain and road bikes.
- Nylon material prevents damage to rims or tires.

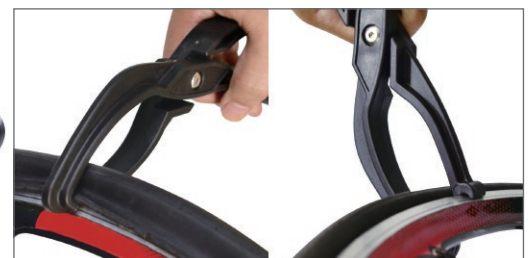



### 65A1 Tire Puncture Repair Kit

- 18 patches
- 8cm valve hose
- 3 tire levers
- A sandpaper
- 10ml adhesive
- Supplied in a tin box



### 65B1 Tire Puncture Repair Refill Kit for Work Shop

- 125ml adhesive with brush
- 3 sandpapers (85 x 45mm)
- 30 patches (Ø42mm)



### 65C1 Puncture Repair Kit for Tubeless Tire

- Plug fork tool
- Patch Strip x 5



### 56P6 Glueless Patch Set AirDam

- Six patches per set



### 56J5 Glueless Patch Set AirDam

- 50 sets 56P6 in jar



### 66G1 10ml Adhesive

- 50 tubes in jar



### 66F1 Tire Sealant

- For all inflatable rubber tubes and tubeless tires
- Contains 120ml and one small piece of valve tool for Schrader and Dunlop valves
- Applicable for tire pressure under 60 PSI
- Suggest replenishing after half year
- One bottle fills 2 tires



### 56E6 Glueless Patch Set AirDam

- Six patches per set

### 56H1 Glueless Patch Set AirDam

- 10 sets #56E6 per card

### 56H2 Glueless Patch Set AirDam

- 20 sets #56E6 per card



### 66L1 Bead Lubricant

- Bead lubricant for tubeless tires (100ml).
- Speeds up tire mounting by sliding tires into rims.
- Dries automatically, no cleanup needed.
- Water-based solution prevents damage to tires.



# Torque Wrenches

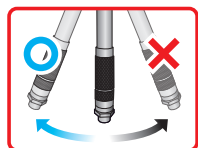

## E211 One-way Torque Wrench

- Operating Range: 21 ~ 105N·m.
- For 3/8" & 1/2" drive sockets
- Supplied in a case

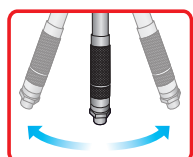
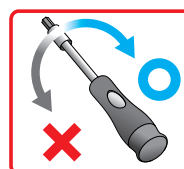

## E214 Two-way Torque Wrench

- Operating Range: 20 ~ 100N·m
- For 3/8" & 1/2" drive sockets
- Supplied in a case

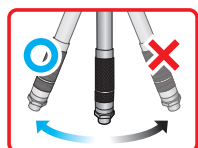

## E215 One-way Torque Wrench

- Operating Range: 2 ~ 24N·m
- For 1/4" drive sockets
- Supplied in a case

## E213 One-way Torque Screwdriver

- Operating Range: 1 ~ 5N·m
- Contains bits of Hex, Pozi®, Phillip, Slot, Torx® (totally 32 bits)
- Contains a 1/4" adaptor
- For 1/4" drive sockets
- Supplied in a case

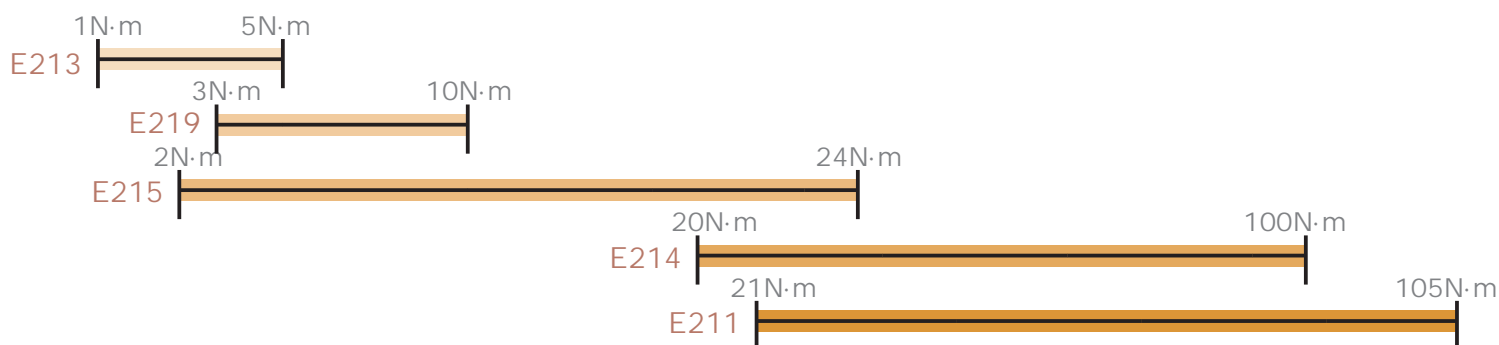

Innovation Award

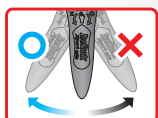

## E219 Ocarina Torque Wrench Set

- Operating Range: 3 ~ 10N·m.
- Lightweight and smart design, ideal for mechanics and riders.
- Easily tightens to the correct torque without setting up torque levels.
- Ergonomic handle holds 3/4/5/6mm hex keys and T-25 in one tool.
- Contents: 3/4/5/6mm hex keys and T-25.





## General Tools



### 16A5 H.S.S. Blade Tube Cutter

- For Ti/ AL/ Cr-Mo/ Steel tubes.
- Not recommended for carbon fiber or threaded tubes (see #16G1 and #16H3).
- For tubes up to 1-5/8" (42mm) diameter.

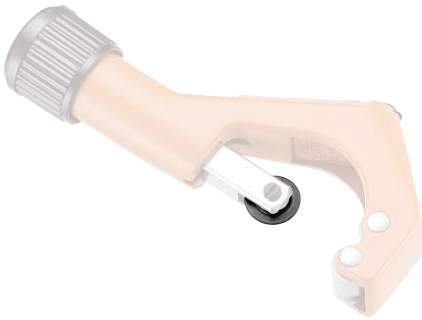

### 16A2S Spare H.S.S. Blade

- For #16A2, #16A4, & #16A5 tube cutters



### 16B1 Tube-End Chamfering Tool

- For easy deburring of sawed-off tubes.
- Suitable for all bicycle tube diameters.
- Deburrs both inside and outside diameters.

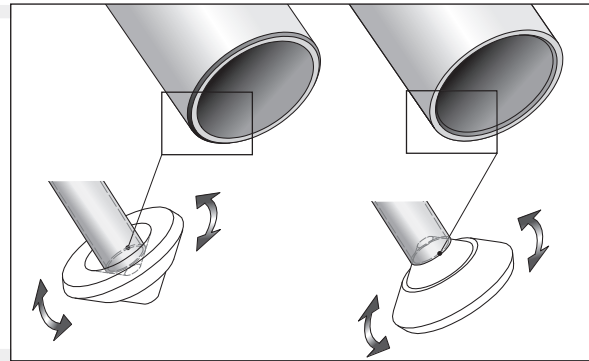

### 16G1 Saw Guide

- 90-degree no-swing design.
- For tubes up to 1-1/4" (32mm).
- Patented.

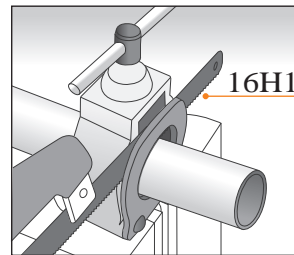
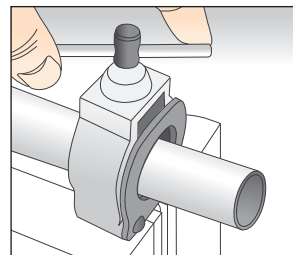
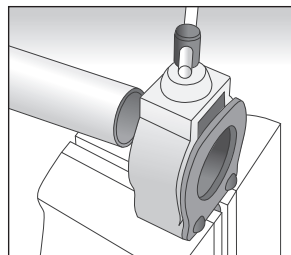

### 17M4 Tape Measure

- Measures up to 3 meters/ 10 feet in centimeters & inches



### 17N1 Rubber Mallet

- When a little force is needed.
- Anti-recoil hammer with beads.
- Coated to prevent marring and marking.
- 2.5 lb/ 1.13 kg.

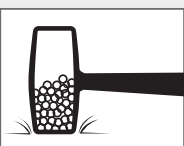



### 25H6 6" Adjustable Forged Wrench

- With scales to 1mm



### 28C2 7" Combination Pliers

- 2-tone handle for comfort grip
- Heat treated CR-V for longer lifespan
- Compact 180mm
- Self-opening jaw



### 28P0 #0 Crosshead (Phillips) Screwdriver with Magnetic Tip

- Ergonomically designed handle for comfortable grip
- 100mm length

### 28P1 #1 Crosshead (Phillips) Screwdriver with Magnetic Tip

- Ergonomically designed handle for comfortable grip
- 100mm length

### 28P2 #2 Crosshead (Phillips) Screwdriver with Magnetic Tip

- Ergonomically designed handle for comfortable grip
- 100mm length



### 28S3 3mm Flat Blade Screwdriver with Magnetic Tip

- Ergonomically designed handle for comfortable grip
- 100mm length

### 28S6 6mm Flat Blade Screwdriver with Magnetic Tip

- Ergonomically designed handle for comfortable grip
- 100mm length



### 28A4 Remover for O-rings, oil seals, and seal pullers

- 6-inch length hooks and picks: straight pick, 45-degree hook, 90-degree hook, full hook.
- 3mm metal diameter for working in tight spaces with ease.
- Protects internal components and allows for easy removal without causing damage.
- Knurled anti-slip design provides stable and secure handling.

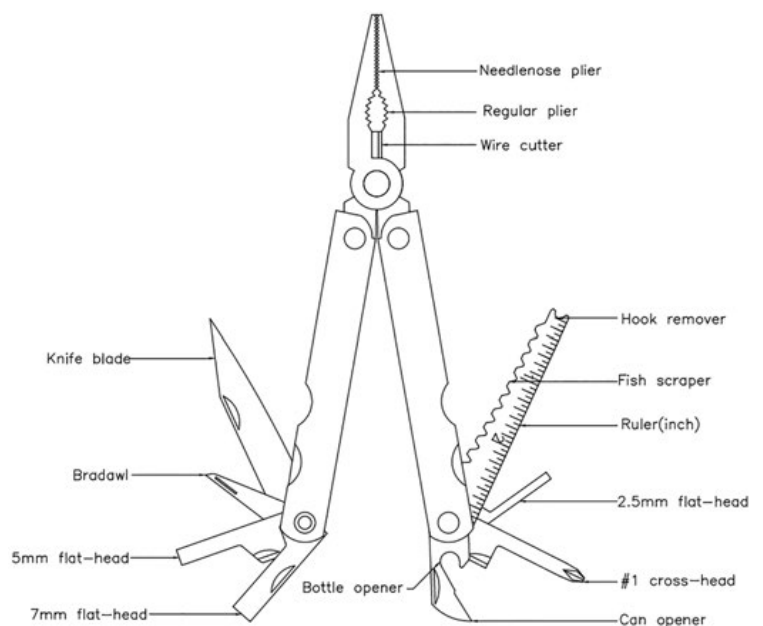

### 40B1 LifeGuard 15-Function Multi-Pliers

- The foldable multi tool contains pliers, needle nose pliers, wire cutter, blade knives, three slotted screwdrivers, bradawl, bottle opener, can opener, Phillips screwdriver, fish scaler, hook remover, carpenter's saw and meters
- Stainless Steel

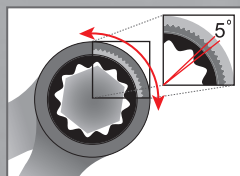

### 4108-4115 Combination Ratchet Wrench

- 8mm (#4108) ~ 15mm (#4115), 5-degree ratcheting



	4108	4109	4110	4111	4112	4113	4114	4115
A	135	158	158	165	166	176	189	196
B	17.85	20.8	20.85	23.3	23.65	25.6	27.95	29.05



### 41B8 8-15mm Combination Ratchet Wrench Set

- Includes storage pouch with two holes for hanging.
- Contains 8pcs Combination Ratchet Wrenches, 8mm (#4108) ~ 15mm (#4115).



### 43L41 Basic 1/2" Drive wrench

- 8mm hex key wrench with 1/2" drive adapter
- 196±5mm/ 7.71" handle



### 43R43 1/2" Two-way Ratchet Wrench

- With quick release function
- 250±5mm/ 9.84" handle



### 60A2 8x9x10mm Y Box Wrench

- With comfortable Kraton grip, Red

### 60D2 12x13x14mm Y Box Wrench

- With comfortable Kraton grip, Black



### 43R41 1/2" Two-way Ratchet Wrench

- With quick release function
- Extra long 395±5mm/ 14.5" handle provides a higher force





### E122 Axle Vise

- Holds a variety of axles securely.
- Prevents axle rotation during wheel hub adjustments.
- Magnets keep jaws firmly in place.
- Suitable for Ø5/ 9/ 10/ 12/ 14/ 20/ 25/ 30/ 36mm axles.

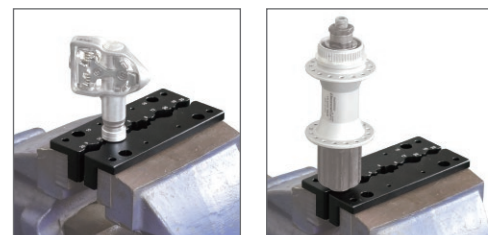

### E158 Complete Tap Set with Handle & Storage Pouch

- E166: M3 x 0.5P, dropout alignment screws
- E167: M5 x 0.8P, water bottle, fenders
- E168: M6 x 1.0P, anti-brakes and large fender bracket
- E169: M10 x 1.0P, derailleur hanger
- E152: 1/2" x 20TPI (left + right), pedal taps
- E154: 9/16" x 20TPI (left + right), pedal taps



### E295 Bearing Puller Kit

- For the removal of bearings and bushings
- Slide hammer with T-handle
- For internal diameter Ø8mm ~ 32mm bearings



### E296 Hub Bearing Installation Kit

- Contacts only the outer ring during installation to prevent damage to the bearing itself.
- Made of 7075 aluminum alloy with CNC machining.
- Treated with anode hard oxidation for durability.

Model	ID x OD	
6000	10 x 26	mm
6001	12 x 28	mm
6900	10 x 22	mm
6901	12 x 24	mm
6902	15 x 28	mm
6903	17 x 30	mm
608	8 x 22	mm
R6	3/8 x 7/8	inch
1526	15 x 26	mm
1728	17 x 28	mm
6800	10 x 19	mm
6801	12 x 21	mm
6802	15 x 24	mm
6803	17 x 26	mm
6804	20 x 32	mm
6805	25 x 37	mm
6806	30 x 42	mm
	24 x 37	mm
	22 x 37	mm

# Hex and Star (Torx®) Wrenches

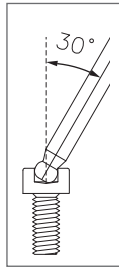

on the wall ①



on the wall ②



## 7M85 TwinHead Wrench Set

- 2 x 2.5 x 3 x 4 x 5 x 6 x 8mm hex key wrenches (ball-ended).
- T-25 star wrench.
- Ball-ended design allows use at up to a 30-degree angle.
- Exceeds ANSI and DIN standards.
- Includes a stand that can be easily mounted to a bench or wall.



70A1 3x4x5mm Hex Key



70B1 4x5x6mm Hex Key

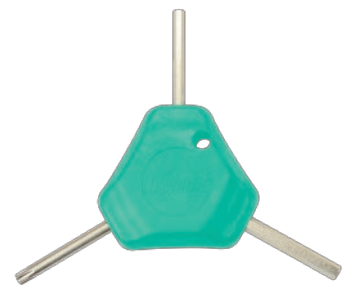

70C1 4x5mm Hex Key + T25



70J2 3-Way with a Screwdriver

- 4 x 5mm hex keys and PH2 screwdriver
- Kraton grip



70T2 Star Key Wrench

- T25 x T30 x T40
- Kraton grip



74A1 6-in-1 Wrench

- 3 x 4 + 5 x 6mm hex keys
- + / - screwdrivers
- Patented



74B1 Perfect Tool for In-line Skate

- Bearing pusher
- 4 x 6mm hex keys
- + / - screwdrivers
- Patented





#### 7M20 2mm TwinHead Hex Key Wrench

- 2mm TwinHead hex key wrench with ball-ended

#### 7M25 2.5mm TwinHead Hex Key Wrench

- 2.5mm TwinHead hex key wrench with ball-ended

#### 7M30 3mm TwinHead Hex Key Wrench

- 3mm TwinHead hex key wrench with ball-ended

#### 7M40 4mm TwinHead Hex Key Wrench

- 4mm TwinHead hex key wrench with ball-ended

#### 7M50 5mm TwinHead Hex Key Wrench

- 5mm TwinHead hex key wrench with ball-ended

#### 7M60 6mm TwinHead Hex Key Wrench

- 6mm TwinHead hex key wrench with ball-ended

#### 7M80 8mm TwinHead Hex Key Wrench

- 8mm TwinHead hex key wrench with ball-ended

#### 7T20 T-20 TwinHead Star Wrench

#### 7T25 T-25 TwinHead Star Wrench

#### 7T30 T-30 TwinHead Star Wrench

#### 35V8 8mm Hex Key Wrench

- With gray coating

#### 35VA 10mm Hex Key Wrench

- With black coating

#### 36H1 Quartet Wrench

- 4 x 5 + 6 x 8mm flex-key wrenches

#### 36Q1 Hex Key Wrench Set

- 2 x 2.5 x 3 x 4 x 5 x 6 x 8mm
- 4 x 5 x 6mm ball-ended



#### 70TA Hex wrench

- 4/ 5/ 6mm hex key



# Multi Tools

## A 91A1 Pocket-17

Hex wrench: 3/ 4/ 5/ 6/ 8mm  
T25, PH1, SL5  
Spanner: 8/ 9/ 10mm  
15mm pedal wrench  
Spoke wrench: 0.127"/ 0.130"/ 0.136"  
Tire lever/ Bottle opener



91.4mm x 47.3mm x 44.5mm

W x H x D



B

## 91B4 Urban-7

Hex wrench: 3/ 4/ 5/ 6mm  
T25, PH1, SL5



88mm x 18mm x 45mm



F

## 94H4 Handy-8

Hex wrench: 3/ 4/ 5/ 6/ 8mm  
T25, PH1, SL5



71mm x 23.3mm x 33.7mm



I

## 95A5 Amaze-11

Hex wrench: 1.5/ 2/ 2.5/ 3/ 4/ 5/ 6/ 8mm  
T25, PH1, SL5



71mm x 21.8mm x 37mm



C

## 91B5 Urban-8

Hex wrench: 3/ 4/ 5/ 6/ 8mm  
T25, PH1, SL5



88mm x 18mm x 45mm



G

## 95A1 Amaze-5

Hex wrench: 4/ 5/ 6mm  
PH1, SL5



72.3mm x 23.3mm x 30.7mm



J

## 95A7 Amaze-19

Hex wrench: 1.5/ 2/ 2.5/ 3/ 4/ 5/ 6/ 8mm



73mm x 24.5mm x 37.2mm



T25, PH1, SL5  
Spanner: 8/ 9/ 10/ 15mm  
Spoke wrench: 14G/ 15G  
Tire lever

D

## 92A1

Hex wrench:  
2/ 2.5/ 3/ 4/ 5/ 6mm  
PH1, SL5



96mm x 19mm x 31mm



H

## 95A3 Amaze-10

Hex wrench:  
1.5/ 2/ 2.5/ 3/ 4/ 5/ 6mm  
T25, PH1, SL5



71.2mm x 21.6mm x 37.2mm

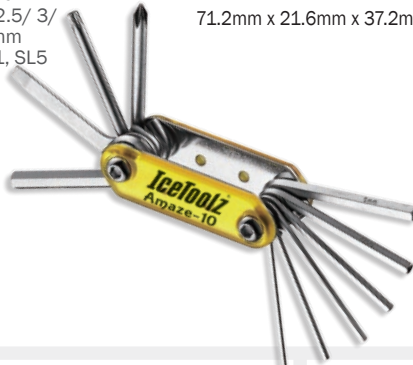

K

## 96B1 Bar-5

Hex wrench: 4/ 5/ 6mm  
PH1, SL5



87.5mm x 19.2mm x 32mm

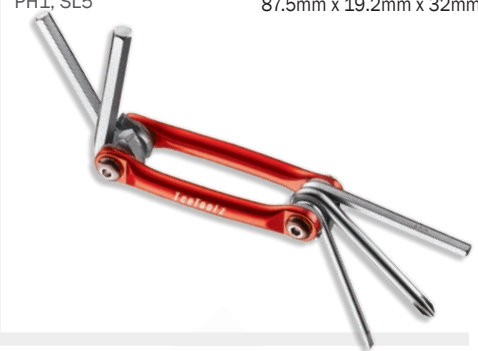

E

## 93B1 Release-20

Hex wrench:  
2/ 2.5/ 3/ 4/ 5/ 6/ 8mm  
PH1, SL5  
Spanner:  
8/ 9/ 10/ 11/ 12/ 13/ 14/ 15mm  
15mm pedal wrench  
Spoke wrench: 14G/ 15G  
Tire lever



83mm x 28mm x 31mm



L

## 96B3 Bar-11

Hex wrench:  
1.5/ 2/ 2.5/ 3/ 4/ 5/ 6/ 8mm  
T25, PH1, SL5



88.2mm x 19.5mm x 53mm



M

**96T1 Star-8**T9/ T10/ T15/ T20/  
T25/ T27/ T30/ T40

87mm x 20.8mm x 38.8mm

O

**97A3**Hex wrench:  
1.5/ 2/ 2.5/ 3/ 4/ 5/ 6mm  
PH1, SL5

80mm x 26mm x 38.3mm

N

**96K2 Blade Man**Hex wrench: 3/ 4/ 5/ 6mm  
PH1, SL5  
Knife/ Bottle opener

83mm x 20mm x 34mm

P

**97B3**Hex wrench:  
1.5/ 2/ 2.5/ 3/ 4/  
5/ 6/ 8mm  
PH1, SL5

80mm x 26mm x 38.6mm

	A	B	C	D	E	F	G	H	I	J	K	L	M	N	O	P
	91A1	91B4	91B5	92A1	93B1	94H4	95A1	95A3	95A5	95A7	96B1	96B3	96T1	96K2	97A3	97B3
HEX 1.5mm					•	•		•	•	•		•			•	•
HEX 2.0mm				•	•			•	•	•		•			•	•
HEX 2.5mm				•	•			•	•	•		•			•	•
HEX 3.0mm	•	•	•	•	•	•		•	•	•		•		•	•	•
HEX 4.0mm	•	•	•	•	•	•	•	•	•	•	•	•		•	•	•
HEX 5.0mm	•	•	•	•	•	•	•	•	•	•	•	•		•	•	•
HEX 6.0mm	•	•	•	•	•	•	•	•	•	•	•	•		•	•	•
HEX 8.0mm	•		•		•	•			•	•		•				•
PH	•	•	•	•	•	•	•	•	•	•	•	•		•	•	•
SL	•	•	•	•	•	•	•	•	•	•	•	•		•	•	•
T9													•			
T10													•			
T15													•			
T20													•			
T25	•	•	•			•		•	•	•		•	•			
T27													•			
T30													•			
T40													•			
8mm spanner	•				•					•						
9mm spanner	•				•					•						
10mm spanner	•				•					•				•		
11mm spanner					•											
12mm spanner					•											
13mm spanner					•											
14mm spanner					•											
15mm spanner					•					•						
12G spoke wrench																
13G spoke wrench																
14G spoke wrench					•					•						
15G spoke wrench					•					•						
15mm pedal wrench	•															
0.127" spoke wrench	•															
0.130" spoke wrench	•															
0.136" spoke wrench	•															
tire lever	•				•					•						
Chain tool (Shimano® 7-10 sp compatible)																
Bottle opener	•													•		
Knife														•		
Weight	226g	132g	135g	132g	176g	118g	118g	142g	150g	156g	92g	156g	120g	148g	146g	154g

## Air Pumps



**A251** VeloAgile High Pressure Alu Mini Pump



**A351** VeloClub High Pressure Alu Mini Floor Pump



**A451** Sport Steel Floor Pump



**A551** Comp Steel Floor Pump



**A652** Extreme High Pressure Floor Pump



**A753** Shock Pump



**A451H** Rubber Hose



**A451V** Twin-Valve

■ For Presta®/ Schrader®/ Dunlop®



**A653** Cannon Air Compressor

- For Tubeless System
- Up to 160psi
- A new innovative valve that for Schrader®/ Presta®/ Dunlop®



		Material	Valve lock	Length	Air pressure
A251	VeloAgile High Pressure Alu Mini Pump	alu	alu thumblock lever	272mm	120 psi 8.2 bar
A351	VeloClub High Pressure Alu Mini Floor Pump	alu	alu thumblock lever	343mm	140 psi 9.6 bar
A451	Sport Steel Floor Pump	steel	twin-valve with thumblock lever	625mm	160 psi 11.0 bar
A551	Comp Steel Floor Pump	steel	twin-valve with thumblock lever	678mm	160 psi 11.0 bar
A652	Extreme High Pressure Floor Pump	alu	alu thumblock lever	658mm	260 psi 18.0 bar
A653	High Pressure Air Tank for Tubeless System	alu	plastic thumblock lever	605mm	160 psi 11.0 bar
A753	Shock Pump	alu	Non-scratch sealed rubber system	225mm	300 psi 20.0 bar



### A810 CO<sub>2</sub> Inflator & Tubeless Tire Repair Kit

- Aluminium alloy body
- Supports Schrader and Presta
- Use with threaded cartridge
- With plug fork tool & 2mm Patch Strip x 5



### A810F CO<sub>2</sub> Inflator & Tubeless Tire Repair Kit

- Aluminium alloy body
- Supports Schrader and Presta
- Use with threaded cartridge
- With plug fork tool & 2mm Patch Strip x 5
- Freeze Protector included



### A812F CO<sub>2</sub> Inflator & Tubeless Tire Repair Kit

- Aluminium alloy body
- Supports Schrader and Presta
- Use with threaded cartridge
- With plug fork tool & 2mm Patch Strip x 5
- Contains 2 cartridges
- Freeze Protector included



### A830 CO<sub>2</sub> Inflator

- Aluminium alloy body
- Supports Schrader and Presta
- Use with threaded cartridge



### A830F CO<sub>2</sub> Inflator

- Aluminium alloy body
- Supports Schrader and Presta
- Use with threaded cartridge
- Freeze Protector included



### A951 Airgun

- Dual Valve Pump Head, 1/4" BSP Inner Wire Type
- Pressure gauge

### A952 Airgun

- Dual Valve Pump Head, ID-8mm Hose Barb Type
- Pressure gauge

### A95A Airgun

- Dual Valve Pump Head, Quick Coupling ARO 210 Type
- Pressure gauge

### A95B Airgun

- Dual Valve Pump Head, Quick Coupling ISO 6150 B Type
- Pressure gauge

### A95C Airgun

- Dual Valve Pump Head, Quick Coupling C Type
- Pressure gauge

### A95E Airgun

- Dual Valve Pump Head, Quick Coupling Euro Type
- Pressure gauge

	Valve type	Weight	Capacity		
A251	Presta®/ Schrader®	112 gram	56 cm <sup>3</sup>	Road bike	Inflating on both ways
A351	Presta®/ Schrader®/ Dunlop®	260 gram	90 cm <sup>3</sup>	Home usage	With gauge
A451	Presta®/ Schrader®/ Dunlop®	1,100 gram	280 cm <sup>3</sup>	Home usage	With gauge (2.5")
A551	Presta®/ Schrader®/ Dunlop®	1,280 gram	300 cm <sup>3</sup>	Both home/store usage	With gauge (2.5")
A652	Presta®/ Schrader®/ Dunlop®	1,320 gram	300 cm <sup>3</sup>	Home usage	With gauge (3")
A653	Presta®/ Schrader®/ Dunlop®	1,760 gram	880cm <sup>3</sup> (at 14.7psi)	Home usage	With safety valve
A753	Schrader®	179 gram	8 cm <sup>3</sup>	Home usage	With gauge



A911

A912



A91A

A91B



A91C

A91E

**A911** Dual Valve Pump Head, 1/4" BSP Inner Wire Type

**A912** Dual Valve Pump Head, ID-8mm Hose Barb Type

**A91A** Dual Valve Pump Head, Quick Coupling ARO 210 Type

**A91B** Dual Valve Pump Head, Quick Coupling ISO 6150 B Type

**A91C** Dual Valve Pump Head, Quick Coupling C Type

**A91E** Dual Valve Pump Head, Quick Coupling Euro Type

## Cleaning & Lubrication



**C123** Sprocket Cleaning Brush

- Up to 12-speed
- For cleaning the bike chain, cassette, mechs and chain wheels

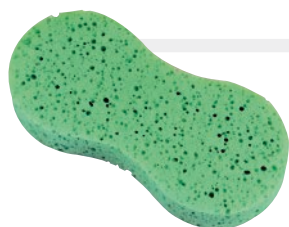

**C125** Cleaning Sponge

- Easy to grip and hold without discomfort.
- Highly absorbent.
- Ideal for washing bikes, cars, vans, and household items.
- Dimensions: 235 x 110 x 38mm.



**C126** Heavy-Duty Microfiber Brush

- Compresses for flexibility and control.
- Safely and effectively cleans rims.
- Cone-shaped head for easy access to hard-to-reach areas.
- Length: 285mm.



**C129** Tube Brush

- Stainless steel bar
- Loop handle
- Ø30mm x 300mmL



**C124** Tire Brush Set

- With stiff bristle for aggressive MTB tires & sprockets cleaning
- Set of 2 pieces



**C145 / C146** Anti-slip Paste

- For assembling parts made of carbon fiber and aluminum alloy
- Keeps parts from moving or loosening and ensures perfect corrosion protection
- Prevents the two components seizing up
- #C145: 5ml, #C146: 17oz. / 500ml

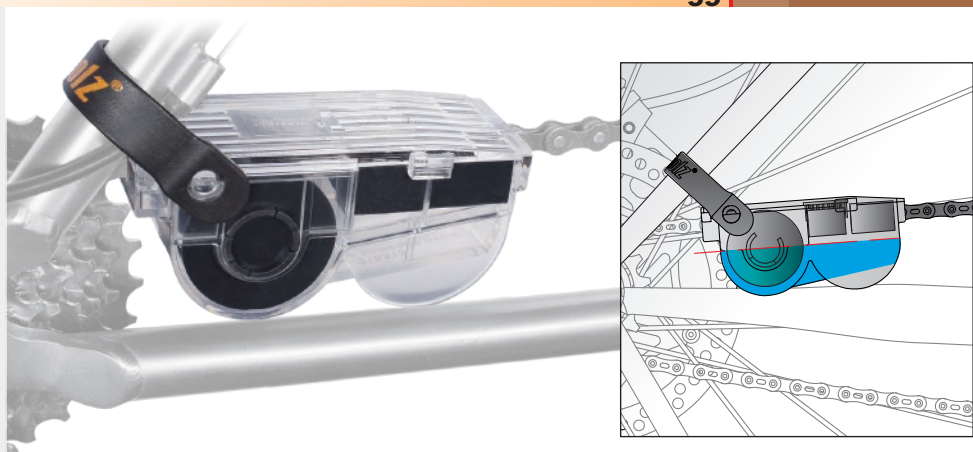

### C115 Chain Scrubber

- Features 20 brushes with a 4-sided scrubber system for spotless chain cleaning.
- Integrated rubber band allows hands-free hanging on the seat stay.
- Enhances cleaning efficiency.
- Includes one spare sponge.
- Patented.



### C115S Spare Parts for Chain Scrubber

- For chain scrubber #C113 & #C115
- Contains brushes and two sponges

### C133



### C134



### C133 Chain Degreaser

- Environmentally friendly concentrated degreaser.
- New formula ensures quick and effective chain cleaning.
- Excellent degreasing performance.
- Non-corrosive to protect your bike components.
- Recommended for use with the #C115 Chain Scrubber.
- Mix ratio: 1 part degreaser to 3 parts water.
- Volume: 4oz / 120ml.

### C134 Jumbo Chain Degreaser

- Environmentally friendly water-based degreaser.
- New formula provides quick and effective chain cleaning.
- Excellent degreasing performance.
- Non-corrosive degreaser to protects bikes and skin.
- Recommended for use with #C115 Chain Scrubber.
- Mix ratio: 1 part degreaser to 3 parts water.
- 15oz / 400ml.



### C137

### C137 E-Bike Drivetrain Cleaner

- Quickly eliminate built up oil, grease and grime
- 14oz. / 425ml



### C141

### C141 PTFE Lubricant

- Contains PTFE & other additives to keep your chain running smooth
- 4oz. / 120ml



### C143

### C143 Cutting Fluid

- For cutting, tapping, facing, and reaming
- Extends the lifespan of the tools
- 2oz. / 60ml



### C147

### C147 Chain Lubricant (for E-Bike)

- Engineered specially for e-Bike chains to withstand high temperature and maintains viscosity during usage
- High cooling capacity and electric insulator
- 4oz. / 120ml



**C161****C162****C161 Dry Lubricant**

- Ideal for dry, dusty, gravel, and dirt environments.
- Decreases dust buildup and component wear.
- Maintains high-speed lubrication.
- Not recommended for wet conditions (use #C141).

**C162 Dry Lubricant with PTFE**

- Ideal for dry, dusty, gravel, and dirt environments.
- PTFE-enhanced formula minimizes dust buildup and component wear.
- Maintains high-speed lubrication.
- Not recommended for wet conditions (use #C141).

**C177 E-Bike Grease**

- Ideally for the circuit and parts of motors in various electric bike
- Non-conductive
- Protects metal against corrosion, heat, and water
- Highly lubricating even with small amount
- Temperature range: -25°C ~ 200°C
- 5ml

**C171 / C172 Anti-wear Copper Grease**

- Protects metal against corrosion, heat, and water
- Ideally for hubs, screws, nuts, bolts, bearings, and BBs
- Highly lubricating even with small amount
- Temperature range: -25°C ~ 200°C
- #C171: 17oz./ 500ml, #C172: 4oz./ 120ml

**C178 Leak-Control Grease Gun**

- Ergonomic design for #C172 Copper Grease

**C184****C182****C183****C182 / C183 / C184 Bike Wash**

- Environmentally friendly bike wash for effective bike cleaning.
- Excellent degreasing performance.
- Non-corrosive; protects bike components.
- Concentrated formula (#C183 & #C184).
- Mix ratio: 1 part bike wash to 1 part water.
- #C182: 10oz./ 300ml
- #C183: 2pt./ 1000ml
- #C184: 10.5pt./ 5000ml



### C189 Bike Cleaning Wipes

- Cleans your bike by breaking down grease, oil, dirt, and more.
- Made with environmentally friendly, non-toxic ingredients.
- Eliminates odors without any pungent smell.
- Towel size: 26 x 30cm.
- 100 sheets.

C191



C192



### C191 Disc Brake Cleaner

- Removes brake dust and oil.
- Reduces brake noise.
- Restores braking performance.
- Leaves no residue.
- Free of CFCs.
- 14oz/ 425ml.

### C192 Grease Remover

- Bubble-based
- 14oz./ 425ml



### C193 Suspension Cleaner

- Cleans dirt adhered to suspension fork stanchions.
- Activates rubber oil seals to extend fork lifespan.
- Keeps dust off while riding to protect friction points.
- 5oz/ 150ml.



### C196 Hand Cleaner

- High degreasing power.
- Antibacterial properties.
- Includes protective agents and proteins for gentle care.
- 10.5pt/ 5000ml.



### C212 Chain Scrubber and Chain Degreaser Combo Set

#### #C115 Chain Scrubber

- Features 20 brushes with a 4-sided scrubber system for spotless chain cleaning.
- Designed for use in forward motion with wheels lifted.
- Rubber band allows hands-free hanging on the seat stay.
- Enhances cleaning efficiency.
- Includes one spare sponge.
- Patented.

**Sold Out**

#### #C133 Chain Degreaser

- Water-based, environmentally friendly degreaser.
- Quick and effective chain cleaning while keeping chains like new.
- Excellent degreasing performance.
- Non-corrosive to protect bikes and skin.
- Mix ratio: 1 part bike wash to 3 parts water.
- 4oz/ 120ml.



### C311 Bike Polisher

- Restores your bike's original shine.
- Forms a thin, protective layer on the bike's surface.
- Non-corrosive, non-toxic, and eco-friendly.
- Suitable for iron, steel, aluminum, titanium, and carbon fiber.
- 14oz/ 425ml.



### C312 Frame Protection

- Reduces damage from sunlight or rain
- Suitable for both matte and clear coating
- 10oz./ 300ml

## Repair Stand



Tools are optional

Steel base  
#E132B  
is optional

### E132 Floor Repair Stand

- Single clamp design.
- Includes tool tray #E132T.
- Optional steel plate (#E132B) available.

### E132B Steel Plate

- Steel plate for #E132 Floor Repair Stand
- 600 x 600 x 8mm



### E138 Professional Repair Stand

- Rotatable clamping mechanism holds Ø25.4 ~ 55mm tubes.
- Quick-release for easy adjustment.
- Foldable for better mobility.
- Sturdy 3-leg design provides stability and portability.
- Contains paper towel holder.
- Includes a carry bag.
- Tool tray (#E132T) and tools are optional.



### E633 SuperLifter-III Repair Stand

- E-bike compatible up to 60kg
- Rotatable rubber clamp for Ø25.4mm ~ Ø55mm
- Adjustable height from 50cm to 180cm (19.7"~70.8")
- 1 turn on the handle = 10cm in height
- Integrated wheels for better indoor and outdoor maneuver
- Large base to support the bike firmly to the top
- Includes integrated work tray
- Patented



E633S Spare Arm Set for #E139,  
#E631 & #E633 SuperLifters



E633Q Metal Quick Release Lever  
for #E631 & #E633 Clamps



### E631D Replacement Clamp Parts

- Includes clamps, rubber pads & screws



### E631P Replacement Rubber Pads for #E631 & #E633



### E631W Replacement wire for #E139, #E631 & #E633 SuperLifters





### E137 Professional Repair Stand

- Rotatable clamping mechanism holds Ø25.4 ~ 55mm tubes.
- Quick-release for easy adjustment.
- Foldable for better mobility.
- Sturdy 3-leg design provides stability and portability.
- Contains paper towel holder.
- Tool tray (#E132T) and tools are optional.

Tool tray and tools  
are optional

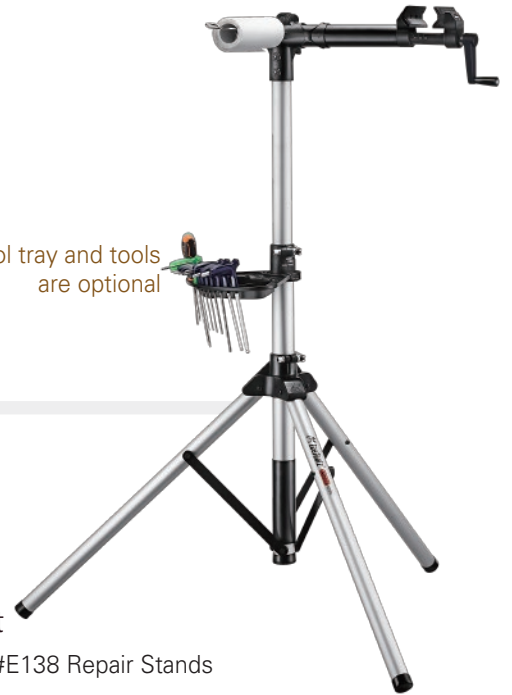

### E137C Spare Clamp

- For #E132, #E134, #E136, #E137, #E138, #E139 Repair Stands



### E137S Spare Arm Set

- For #E132, #E134, #E137, #E138 Repair Stands



### E614 Rotatable Race Stand

- 360-degree rotatable for versatile use.
- Ideal for bike servicing, setup, and cleaning.
- Crossbar compatible with all fork and rear dropouts.
- Adjustable to fit various bike types.
- Includes a strap to securely hold the frame for added safety.
- Auto-adjustable foot pads ensure stability on uneven floors.
- Supports up to 25kgs/ 55.12lbs and a height of 90cm/ 3'.
- Includes a carry bag.

### E621 Franky Repair Stand

- Large foot design for a sturdy base.
- Foldable for easy storage and transportation.
- Supports up to 20kgs/ 44lbs and a height of 152cm/ 59.84'.

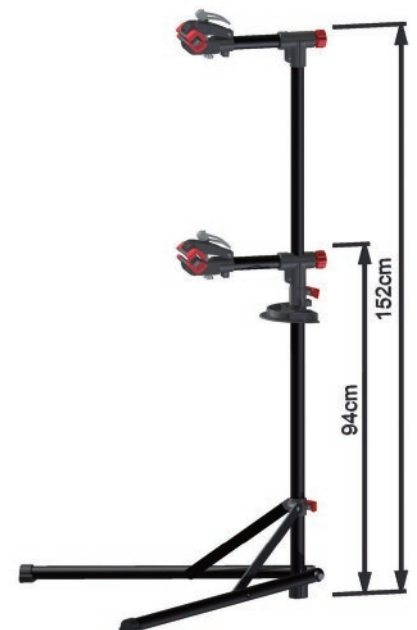

# Tool Kits

## 82F4 Essence Tool Kit



- #04C2: Crank Remover
- #64P3: Tire Lever Set, Set of 3 Pieces
- #25H6: 6" Forged Adjustable Wrench
- #39H4: 9 x 10mm Open-ended Wrench
- #35V8: 8mm Hex Key Wrench
- #29M1: Shimano® Compatible Chain Tool (5 x 6 x 7 x 8 x 9 x 10 x 11 x 12-speed)
- #D8D4: Connecting Tool (from 8mm changing to 1/2")
- #09C1: Cassette Lockring Tool with Guide Pin
- #36Q1: 2/ 2.5/ 3/ 4/ 5/ 6 Hex Key Wrench 4x5x6mm Ball-end
- #28P1: #1 Philips Screwdriver
- #28S6: 6mm Flat Blade Screwdriver
- #34S4: Lockring Tool, Freewheel Turner, and 15mm Pedal Wrench
- #11F3: Shimano® Hollowtech II Compatible BB Tool
- #12F8: 10-15G Forged 8-groove Spoke Tool
- #35T25: T-25 Torx Wrench, 20 x 100mmL
- #11B1: Shimano® / ISIS Drive BB Tool
- Product Dimensions: 30.5 x 21 x 6.5cm
- Weight: 1.8kg
- Color: Black

## 82F6 CarbonFix Tool Kit



### The tool set for maintaining your beloved carbon fiber bicycle

- Effortlessly handles bike adjustments, cleaning, maintenance, and basic repairs.
- Includes a precision 3-10Nm torque wrench to safeguard your bike from damage due to overtightening.
- Chain pliers for a safe chain cleaning with harsh detergents.
- Never lose the adapter with a thoughtfully designed storage space.
- #09C1: Cassette Lockring Tool with Guide Pin
- #34S4: Lockring Tool, Freewheel Turner, and 15mm Pedal Wrench
- #35V8: 8mm Hex Key Wrench
- #36Q1: 2/ 2.5/ 3/ 4/ 5/ 6 Hex Key Wrench, 4x5x6mm Ball-end
- #62C4: Stainless Steel Go / No-go Chain Checker
- #62D3: Master Link Pliers
- #64P3: Tire Lever Set, Set of 3 Pieces
- #96T1: T9/ T10/ T15/ T20/ T25/ T27/ T30/ T40 Torx® compatible wrench
- #C145: Anti-slip Paste
- #D8D4: Connecting Tool (from 8mm changing to 1/2")
- #E219: Ocarina Torque Wrench Set

## 82A6



- #04C2: Crank Remover
- #64P3: Tire Lever Set, Set of 3 Pieces
- #25H6: 6" Forged Adjustable Wrench
- #11H1: Lockring Tool
- #39H4: 9 x 10mm Open-ended Wrench
- #35V8: 8mm Hex Key Wrench
- #29C4: Shimano® Compatible Chain Tool (6x7x8x9-speed)
- #0502: 13 x 15 + 14 x 16mm Cone Wrench Set, 2 Pieces
- #09C5: Freewheel / Cassette Lockring Tool
- #36Q1: 2/ 2.5/ 3/ 4/ 5/ 6 Hex Key Wrench, 4 x 5 x 6mm Ball-end
- #P1P2 #1/#2 Philips Screwdriver

- #S4S6: 4/6mm Flat Blade Screwdriver
- #3400: 15mm Pedal Wrench & 14x15mm sockets
- #53A2: Multi-speed Freewheel Turner (Chain Whip, 1/2" x 3/32")
- #06H8: 30 x 32 + 36 x 40mm headset wrench
- #11F3: Shimano® Hollowtech II Compatible BB Tool
- #12F8: 10-15G Forged 8-groove Spoke Tool
- #35T25: T-25 Torx Wrench, 20 x 100mmL
- #11B3: Shimano® / ISIS Drive BB Tool
- Product Dimensions: 30.5 x 21 x 6.5cm
- Weight: 2.65kg
- Color: Silver

## 85A5 Advanced Mechanic Tool Kit



- Carry Case
- #11B1: Shimano® / ISIS Drive BB Tool
- #09C1: Cassette Lockring Tool with Guide Pin
- #M091: BB Installation Tool for Shimano® Hollowtech II
- #C123: Sprocket Cleaning Brush
- #12F8: 10-15G Forged 8-groove Spoke Tool
- #17M4: Tape Measure, Up to 3M/ 10FT
- #04C2: Crank Remover
- #3TA1: Star Key Wrench (T-10 x 15 x 20 x 25 x 30 x 40 x 45 x 50)
- #36Q9: Hex Key Wrench Set w/Ball-ended (1.5 x 2 x 2.5 x 3 x 4 x 5 x 6 x 8 x 10mm)
- #67B4: Cable Cutter
- #25H6: 6" Forged Adjustable Wrench
- #47X7: 13x14x15x16x17x18x19mm Cone Wrench Set
- #33F5: 15mm Pedal Wrench
- #62M1: Pro Shop Chain Tool (for 5 x 6 x 7 x 8 x 9 x 10 x 11 x 12-speed)
- #28P1: #1 Philips Screwdriver
- #28S6: 6mm Flat Blade Screwdriver
- #64P3: Tire Lever Set, Set of 3 Pieces
- #53A2: Multi-speed Freewheel Turner (Chain Whip, 1/2" x 3/32")
- #53R4: 1/2" Two-way Ratchet Wrench
- Product Dimensions : 37.8 x 16.8 x 14.5cm
- Weight: 5.4kg
- Color: Black



## 84S2 Starter Tool-Roll



- Keeps your cycling accessories organized and accommodate in the Starter Tool-roll
- The simple, versatile design allows you to stow all sorts of tools
- Durable polyester storage roll
- Simple roll-up design carries essential ride necessities
- Contains :
  - #28S6: 6mm flat blade screwdriver with magnetic tip
  - #28P1: #1 Philips screwdriver with magnetic tip
  - #29M1: Shimano® compatible chain tool (5 x 6 x 7 x 8 x 9 x 10 x 11 x 12-speed)
  - #36Q1: 2/ 2.5/ 3/ 4/ 5/ 6 hex key wrench, 4 x 5 x 6mm ball-ended
  - #65A1: Tire puncture repair kit (18 patches, 3 tire levers, 10ml adhesive, 8cm valve hose, A sandpaper)
  - #C123: Sprocket cleaning brush (up to 10-speed for aggressive cleaning)

## 801A



- #1100: 15mm wrench & locking tool
- #1206: 10-15G Forged 6-groove Spoke Tool
- #25H6: 6" Adjustable Forged Wrench
- #60A2: 8 x 9 x 10 Y box wrench
- #60D2: 12 x 13 x 14 Y box wrench
- #64P3: Tire Lever Set, Set of 3 Pieces
- 4 x 5 x 6 x 8 Hex key
- 4 x 6mm flat blade screwdriver
- #1 x #2 Philips screwdriver

## 83A1 Storage Bottle



Product includes tire lever x 3,  
glue, patch x 18



Image contains for reference only

- Keeps your tools and spares secure and protected, in a safe spot when you need them the most
- PE material bottle case, strong and durable for holding tools
- Bottle shaped case, portable and convenient for outdoor use

## 83A2 Storage Bottle



- Keeps your tools and spares secure and protected, in a safe spot when you need them the most
- PE material bottle case, strong and durable for holding tools
- Bottle shaped case, portable and convenient for outdoor use

## 85A7 Pro Shop Mechanic Tool Kit



- Carry Case
- #C153: Pro Shop Apron
- #53R4: 1/2" Two-way Ratchet Wrench
- #33S1: 15mm Pedal Wrench
- #53S3: Multi-speed Freewheel Turner (Chain Whip, 1/2" x 3/32")
- #C123: Sprocket Cleaning Brush
- #0502: 13 x 15 + 14 x 16mm Cone Wrench Set, 2 Pieces
- #62M1: Pro Shop Chain Tool (for 5 x 6 x 7 x 8 x 9 x 10 x 11 x 12-speed)
- #04C2: Crank Remover
- #09C1: Cassette Lockring Tool with Guide Pin
- #12F8: 10-15G Forged 8-groove Spoke Tool
- #56E6: Glueless Patch Set AirDam, 6 Pieces
- #M091: BB Installation Tool for Shimano® Hollowtech II
- #30C1: ChainMaster
- #67B4: Cable Cutter
- #97T1: "Star-8" T-9 x 10 x 15 x 20 x 25 x 27 x 30 x 40 Star Keys
- #97A3: "Mighty-9" 1.5 x 2 x 2.5 x 3 x 4 x 5 x 6mm Hex Keys, +/- Screwdrivers
- #25H6: 6" Forged Adjustable Wrench
- #35V8: 8mm Hex Key Wrench
- #64P3: POM Tyre Levers, Set of 3 Pieces
- #28P1: #1 Philips Screwdriver
- #28S6: 6mm Flat Blade Screwdriver
- #27P5: Chainwheel Nut Tool
- Product Dimensions: 37.8 x 16.8 x 14.5cm
- Weight: 4.9kg
- Color: Black



## Display & Storage



### P413 Event and Display Stand

- Holds up to 10 bikes by the saddle.
- Includes a rubber stripe at the top to protect the saddle rail.
- Quick-release function for easy assembly and disassembly.
- Includes a carry bag and mesh pockets on both sides.
- Maximum Load: 100kg.
- Optional extension kit #P411S.
- Size: 2,760 x 810 x 1,215mm

### P411S Event and Display Stand Extension Kit

- For #P412 and #P413
- Extends 4 ~ 6 bikes
- Size: 1,470 x 810 x 1,215mm



### P643 Stand-By-Me

- Bike stand for display and repair.
- Adjustable chain stay holder for height and angle to fit various frame sizes and styles.
- Maximum Load: 25kg.



### P646 Rear Axle Bike Stand

- Up to 29"
- Maximum Load: 25kg
- Patented



### P655 Two-way Storage Hook

- For slat wall or regular wall
- Maximum Load: 20kg
- Patented



### P621 Eagle Bicycle Lifter

- Dual pulley system
- Maximum Load: 25kg
- Maximum Height: 3 meters

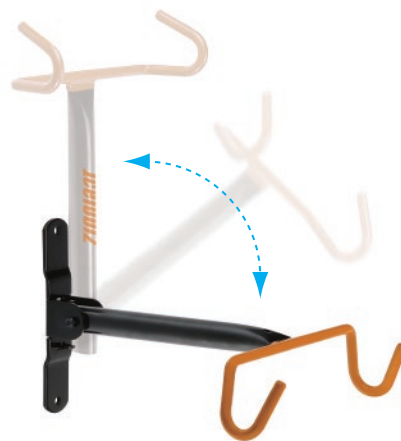

### P631 Bull Storage Rack

- Foldable for compact storage.
- Maximum Load: 20kg.



### P678 Hook with Roller

- Designed for fatter tires up to 70mm width.



### P685 Hook with Dowel

- Designed for fatter tires up to 70mm width.
- Maximum Load: 20kg.



### P679 Hook with Roller

- Designed for fatter tires up to 70mm width.

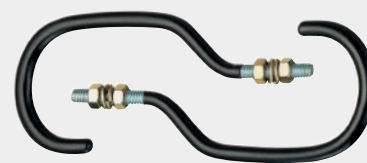

### P686 Storage Hooks - Machine Thread with Nuts and Spring Washers

- Set of 2 pieces
- Black vinyl coated
- Maximum Load: 20kg per hook



### P684 Storage Hooks - Wood Thread with Dowels

- Set of 2 pieces
- Black vinyl coated
- Maximum Load: 20kg per hook



### P688 Hook with Dowel

- Designed for fatter tires up to 70mm width.
- Maximum Load: 20kg.

## Safety



**F164** Safety Flag, one-piece, length 60", white fiberglass pole

**F168** Safety Flag, one-piece, length 60", orange fiberglass pole



**F264** Safety Flag, two-piece, length 60", white fiberglass pole

**F268** Safety Flag, two-piece, length 60", orange fiberglass pole

**F274** Safety Flag, two-piece, length 72", white fiberglass pole



**F364** Safety Flag, three-piece, length 60", white fiberglass pole

**F374** Safety Flag, three-piece, length 72", white fiberglass pole



**21C2** ABS Trouser Clips

- With 3M® Scotchlite reflective sheeting

## Accessories



**17G2-17G4-17G6** NBR Gloves

- Keeps your hands clean of oils, acids, and dirt while maintaining a natural feel.
- 100 pcs per box.

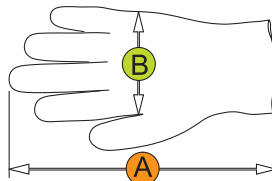

Item	17G2	17G4	17G6
Size	M	L	XL
A	23cm	23cm	23cm
B	9.5cm	10.5cm	11.5cm

± 0.5cm

- 100 PCS/BOX.
- Powder-Free.
- Protein-Free.
- High Flexibility.
- Textured.
- Non-Sterile.
- Ambidextrous.
- Anti-Oil.
- Acid Resistant.
- Alkali Resistant.



**17D1** Phone Holder Silicone

- Suitable for mounting on handlebars with diameter 22 to 38 mm
- Suitable for phones between 6.0 ~ 9.0 x 12.0 ~ 16.0 cm
- High resistance to environmental influences and UV radiation
- Remains flexible at both high and low temperatures
- Tool-free mounting



**C155** Pro Shop Apron

- Double zip center pockets, dual open side pockets, and single zip chest pocket
- Tough enough for a pro shop & comfortable enough for home use



## Andorra

### Race Company

Tel : +33(0)490.04.46.60  
e-mail : contact@racecompany.fr  
http://www.racecompany.fr

## Argentina

### ARIES COMERCIAL S.A.

Tel : +54 11 4788 3370  
e-mail : info@aries-comercial.com  
http://www.aries-comercial.com/

## Australia

### GPI Apollo Bicycles

Tel : +613 9700-9400  
e-mail : sales@apollobikes.com  
http://apollobikes.com

## Austria

### BBF Bike GmbH

Tel. +49(0)3342. 354 325  
e-mail : info@bbf-bike.de  
http://www.bbf-bike.de

## Belgium

### Buzaglo BV

Tel : +31 36.521-0100  
e-mail : info@buzaglo.nl  
http://www.buzaglo.nl

## Brazil

### Isapa Importacao e Comercio Ltda.

Tel : +5511.2823-6500  
e-mail : bike@isapa.com.br  
http://www.isapa.com.br

## Bulgaria

### Velomania LTD

Tel : +359 2 812 7060  
e-mail : info@velomania-bg.com  
http://www.velomania-bg.com

## Canada-1

### Orange Sport Supply, Inc.

Tel : +1 604.990-5110  
e-mail : info@orangesportsupply.com  
http://www.orangesportsupply.com

## Canada-2

### D'Amour Bicycle & Sports Inc.

Tel : +1 514-6376511 / +1 800 363-8743  
e-mail : info@damourbicycle.com  
http://www.damourbicycle.com

## Chile

### Oxford S.A.

Tel : +56.22.2463-2045  
e-mail : enzoe@oxford.cl  
http://www.OxfordStore.cl

## China

上海晨瑞商贸有限公司  
Tel : +86 21.3358-0260  
e-mail : srchen@live.cn

## Columbia

### HA Bicicletas S.A.

Tel : +57 4.285-5040  
e-mail : servicioalcliente@habicicletas.com  
http://www.habicicletas.com

## Czech

### Profil Bicycles CZ

Tel : +420.7394-73391  
e-mail : profil.bicycles@iol.cz  
http://www.profil-bicycles.cz

## Ecuador

### Importadora Comercial Sucre Cia. Ltd.

Tel : +593 2.247-8625  
e-mail : ics@uio.satnet.net  
http://www.importadorasucre.com

## France

### Race Company

Tel : +33(0)490.04.46.60  
e-mail : contact@racecompany.fr  
http://www.racecompany.fr

## Germany

### BBF Bike GmbH

Tel. +49(0)3342. 354 325  
e-mail : info@bbf-bike.de  
http://www.bbf-bike.de

## Greece

### Velomania LTD

Tel : +359 2 812 7060  
e-mail : info@velomania-bg.com  
http://www.velomania-bg.com

## Guatemala

### Bicicletas Mercurio S.A. de C.V.

Tel : +52 444-1442-400  
e-mail : contacto@windsorsportsgroup.com  
http://www.windsorsportsgroup.com

## Hungary

### Biker Kft

Tel.: +36 1.278-1021  
e-mail : biker@biker.hu  
http://www.biker.hu

## India

### Extreme Adventure Sports

Tel : +91 20 6605 0600  
e-mail : raman.jpa@gmail.com  
www.exadsports.com

## Ireland

### Solent (UK) Ltd, T/A Windwave

Tel : +44 23.9252-1912  
e-mail : sales@windwave.co.uk  
http://www.windwave.co.uk

## Italy

### RMS SPA

Tel : +39 0362.27301  
e-mail : info@rms.it  
http://www.rms.it

## Japan

### Rinei Company Ltd. / リンエイ株式会社

Tel : +81 58-247-3190  
e-mail : info@gifu-rinei.jp  
http://www.rinei-web.jp/

## Korea

### Fours, Inc.

Tel : +82-31-635-6520  
e-mail : jang@fours.co.kr  
http://www.fours.co.kr

## Luxembourg

### Buzaglo BV

Tel : +31 36.521-0100  
e-mail : info@buzaglo.nl  
http://www.buzaglo.nl

## Malaysia

### Guan Chow Sdn Bhd

Tel : +60 5.253-1578  
e-mail : gccycle@gmail.com  
http://www.gccycle.com

## Mexico

### Bicicletas Mercurio S.A. de C.V.

Tel : +52 444-1442-400  
e-mail : contacto@windsorsportsgroup.com  
http://www.windsorsportsgroup.com

## Netherlands

### Buzaglo BV

Tel : +31 36.521-0100  
e-mail : info@buzaglo.nl  
http://www.buzaglo.nl

## New Zealand

### H S White & Son Limited

Tel : +64 6.350-2440  
e-mail : gillian@hswhite.co.nz  
http://www.hswhite.co.nz

## Norway

### Deler AS

Tel : +47 6498-9950  
e-mail : post@deler.no  
http://www.deler.no

## Paraguay

### Cyclesport S.A.

Tel : +595 21.450-512  
e-mail : carlos\_gonzalez@e-cyclesport.com  
http://www.e-cyclesport.com

## Peru

### Oxford S.A.- Sucursal Peru

Tel : +51 21.450-512  
e-mail : dbalarezo@oxfordperu.com  
http://www.oxfordstore.pe

## Philippines

### Champ Bike

Tel : +63 905.370-5648  
e-mail : champ@chambbikeph.com  
https://www.facebook.com/chambbikeph

## Poland

### Unibike Sp.J.

Tel : +48 52.348-9611~13  
e-mail : unibike@unibike.pl  
http://www.unibike.pl

## Portugal

### Ciclo Coimbrões - Joaquim Leite Comércio de Velocipedes, Lda.

Tel : +351 22.370-9772  
e-mail : geral@ciclocoimbroes.com  
http://www.ciclocoimbroes.com

## Romania

### SC Velomania SRL

Tel : +40 031 805 99 06  
e-mail : sales@dragzone.ro  
http://www.dragzone.ro/

## Russia

### Maximum company / Компания Максимум

Tel : +7 (812) 740-79-62  
e-mail : maximum@msgbox.ru  
http://st-peterbike.ru

## S. Africa

### Chris Willemse Cycles

Tel : +27 21 914-7528  
e-mail : cwcycles@telkomsa.net  
http://www.cwcycles.co.za

## Singapore

### Guan Chow Sdn Bhd

Tel : +60 5.253-1578  
e-mail : gccycle@gmail.com  
http://www.gccycle.com

## Spain

### Comet S.L.

Tel : +943 331-393  
e-mail : comet@comet.es  
http://www.comet.es

## Switzerland

### Schmid Bike Parts AG

Tel : +41 44.836-6131  
e-mail : info@schmidbikeparts.ch  
http://www.schmidbikeparts.ch

## Taiwan

### 達陸國際股份有限公司

Tel : +886 4 835 3575  
e-mail : dalux.krex@gmail.com  
http://www.krex.com.tw

## Thailand

### Asia International Business & Sales Co., Ltd. / บริษัท เอเชียอินเตอร์เนชั่นแนลบิสเนสแอนด์เซลส์ จำกัด

Tel : +66 2887-7813~4  
e-mail : info@asiabike.com  
http://www.asiabike.com

## Turkey

### Kron Bisiklet A.Ş.

Tel : +90 444 27 98  
e-mail : info@kronbisiklet.com.tr  
http://www.kronbisiklet.com.tr

## U.S.A.

### Luckybird LLC

Tel : +1(509)-842-8662  
e-mail : aidan@luckybirdbrands.com  
www.luckybirdbrands.com

## UK

### Solent (UK) Ltd, T/A Windwave

Tel : +44 23.9252-1912  
e-mail : sales@windwave.co.uk  
http://www.windwave.co.uk

## Ukraine

### Veloplaneta Ltd.

Tel : +38 050 402 37 05  
e-mail : veloplaneta@gmail.com  
http://www.veloplaneta.com.ua

## Uruguay

### Juan J. Brogioli e Hijos S.A.

Tel : +598 22 01 01 84  
e-mail : ventas@juanbrogioli.com.uy  
http://www.juanbrogioli.com.uy

## Venezuela

### Importaciones Imremo C.A.

Tel : +58 4141299021  
e-mail : imremoca@gmail.com



[www.icetoolz.com](http://www.icetoolz.com)  
[contact@icetoolz.com](mailto:contact@icetoolz.com)



***Lifu Bicycle Co., Ltd.***

No. 4, Lane 11, Ziqiang Street, Tucheng District  
New Taipei City 236043, Taiwan

Tel: +886 2.2268-7367

Fax: +886 2.2268-1947